

POWER TOOLS, JIGS & ACCESSORIES

TOOLBOX

Darbagaldi & Instrumenti

www.TOOLBOX.lv

info@toolbox.lv

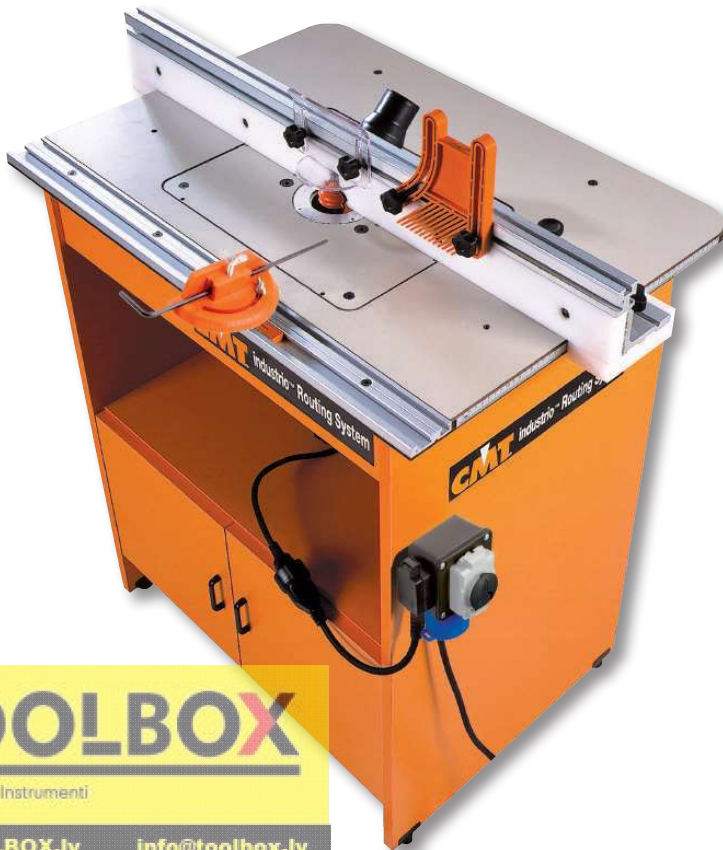

PRODUCTS	PAGE
Routers & Trimmer	352~354
Oscillating Multi-Tools	355
Router Tables	356-357
Pocket-Pro™ Joinery System	358
Small Stock Holder	359
Professional Straight Edge Clamps	360
Adjustable Precision Router Dado Jig	361
Universal Dovetail Jig	362-363
Eclipse & Circle Cutting Jig	364
Kitchen Worktop Jig	365
Universal Hinges Boring Systems	366~368
Bench Block Set	368
Inlay & Template Guide Kit	369
Universal Boring Template and Jig	370-371
3D Router Carver System	372~374
Organizer	374
Tools Cleaner & Lubricant	375
Flexible Templates for Routing	376
Edge Banding Jigs	377
Digital Height Gauge	378
Digital Moisture Meter	378
Digital Angle Gauge & Finder	379
Diamond Whetstones	380
Bowl & Tray System	381
Folding Ruler	382
Carpenter Pencil	382
CMT Professional Tool Bag	382

TOOLBOX

Darbagaldi & Instrumenti

www.TOOLBOX.lv

info@toolbox.lv



1KW Router

CMT8E

QUICK ACCESS BRUSHES

change worn brushes quickly and easily.



SAFETY SWITCH SHUTTER

locks during bit change mode to prevent accidental power on.

SIDE AIR VENTS

reduces intake of dust into the motor casing when mounted upside-down in a router table.

ELECTRONIC SPEED CONTROL & SOFT START

From 8.000 - 20.000 RPM.

FULLY ENCLOSED GUARDING

provides maximum protection from the cutting zone.

MULTI-FUNCTION FENCE

provides excellent control for hand-held use and circle cutting.

QUICK FIT PINS

for fast fitment and removal from its fence.



TOP OF TABLE HEIGHT ADJUSTMENT

Top of table height adjustment is possible using the height winder handle from the template guide kit.



Optional

Clamping nuts and collets for CMT8E and CMT7E

DIAMETER	ORDER NO.
D = 6mm	796.660.00
D = 6,35mm	796.664.00
D = 8mm	796.680.00
D = 10mm	796.700.00
D = 12mm	796.720.00
D = 12,7mm	796.727.00



Optional



DESCRIPTION	ORDER NO.
Prebored router plate for CMT7E and CMT8E	CMT300-SB
Guide bush Ø30mm	899.007.00

TECHNICAL SPECIFICATIONS

- Power 1 KW
- Input 220/230V (50/60Hz)
- No load speed 8.000-20.000 RPM
- Plunge stroke 0-59mm
- Collet diameter Ø6-12,7mm
- Tool weight 3,8 Kg

STANDARD EQUIPMENT

- Extended baseplate with adjustable fence
- Fine micrometric adjustment knob.
- Dust extraction outlet
- Easy adjustment
- Wrench for easy cutter change

- Ø8 and Ø12mm collets
- 1 year warranty
- Instruction manual

Worldwide Technical Assistance

DESCRIPTION	ORDER NO.
Router complete with standard equipment	CMT8E

2.4KW Router



CMT7E



REMOVABLE PLUNGE SPRING

for easy bit adjustment when table mounted.



ELECTRONIC SPEED CONTROL & SOFT START

From 8.000 - 20.000 RPM

SWITCH FROM A PLUNGE TO A FIXED BASE ROUTER

by simply pressing or releasing the button.



QUICK ACCESS BRUSHES

change worn brushes quickly and easily.



SAFETY SWITCH SHUTTER

locks during bit change mode to prevent accidental power on.

FULLY ENCLOSED GUARDING

provides maximum protection from the cutting zone.

MULTI-FUNCTION FENCE

provides excellent control for hand-held use and circle cutting.

SIDE AIR VENTS

reduces intake of dust into the motor casing when mounted upside-down in a router table.

3 STAGE TURRET

with direct reading scales (mm) for precise preset cut depths.



QUICK FIT PINS

for fast fitment and removal from its fence.



TOP OF TABLE HEIGHT ADJUSTMENT

Top of table height adjustment is possible using the height winder from the template guide kit.

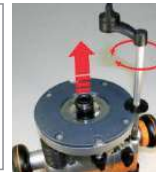

Watch the video on



STANDARD EQUIPMENT

- Extended baseplate with adjustable fence
- Dust extraction outlet
- Infinite micro adjustment
- Wrench for easy cutter change
- Ø8 and Ø12mm collets
- 1 year warranty
- Instruction manual

Worldwide Technical Assistance

Optional

Clamping nuts and collets for CMT8E and CMT7E

DIAMETER	ORDER NO.
D = 6mm	796.660.00
D = 6,35mm	796.664.00
D = 8mm	796.680.00
D = 10mm	796.700.00
D = 12mm	796.720.00
D = 12,7mm	796.727.00



Optional



DESCRIPTION	ORDER NO.
Prebored router plate for CMT7E and CMT8E	CMT300-SB
Guide bush Ø30mm	899.007.00



TECHNICAL SPECIFICATIONS

- Power 2.4 KW
- Input 220/230V (50/60Hz)
- No load speed 8.000-20.000 RPM
- Plunge stroke 0-68mm
- Collet diameter Ø6-12,7mm
- Tool weight 6,3 Kg

DESCRIPTION

Router complete with standard equipment



Darbagaldi & Instrumenti

www.cmtorangetools.com

www.TOOLBOX.lv

info@toolbox.lv

550W Professional Trimmer



CMT10

TOOLBOX

Darbagaldi & Instrumenti

www.TOOLBOX.lv

info@toolbox.lv



DESCRIPTION		ORDER NO.
550W Professional Trimmer	8	CMT10

Standard Equipment



Aluminium-embossed scale for accurate setting of the desired routing depth



Trimmer guide with Delrin® roller prevents marks on the workpiece



Fine depth adjustment



CMT10-54
Ø10mm guide bush

Standard Equipment

- Extended baseplate with adjustable fence
- Trimmer guide
- Guide bush
- 2 wrenches for easy cutter replacement (12 and 17mm)
- Ø6mm and Ø8mm collet
- 1 year warranty
- Instruction manual

Worldwide Technical Assistance

TECHNICAL SPECIFICATIONS:

- Power 550 Watt
- Input 220/230V (50/60Hz)
- No load speed 32.000 RPM
- Plunge stroke 0-24mm
- Collet diameter..... Ø6-8mm
- Tool weight..... 1,6 Kg

Spare parts



CMT10-16A
Dust guard & base plate



CMT10-17
Clamping nut



CMT10-18 Collet Ø6mm
CMT10-18A Collet Ø6,35mm
CMT10-18B Collet Ø8mm



CMT10-30
Pair of carbon brushes

CMT11

FAST LOCK



SPEED CONTROL 1-6

MULTI MATERIALS & APPLICATIONS:



- GRINDING
- SAWING
- JOINT OPENING
- PLASTIC CUTTING
- CARPET REMOVAL
- PLUNGE CUTTING
- WOOD CUTTING
- CUTTING LAMINATE SHEETS
- TUBE LENGTH TRIMMING
- NAIL CUTTING



FAST LOCK

TOOLBOX
 Darbagaldi & Instrumenti
www.TOOLBOX.lv info@toolbox.lv



INCLUDED:

HANDLE

VACUUM HOSE

Standard Equipment

- 1 x Oscillating Multi-tool
- 1 x handle
- 1 x vacuum hose
- 1 x manual
- 1 x plastic carry case

TECHNICAL SPECIFICATIONS:

- Power300 Watt
- Input220/230V (50/60Hz)
- No load speed11.000~21.000 RPM
- aw (vibration)19,7m/s² - K=1,5m/s²
- Tool weight1,5 Kg

DESCRIPTION	ORDER NO.
300W Oscillating Multi-Tools	CMT11

Worldwide Technical Assistance



New Professional Router Table

CE Approved

CMT ORANGE TOOLS

999.110.00

Router table dimensions:
80x60x(h)90cm. - 26,5 kg. weight

Our quality bits have been designed for you, the professional craftsman, to allow you to confidently work at your best. CMT now offers even more possibilities with our professional router table: the perfect place to combine your skills and CMT quality.

The professional router table system has a strong and sturdy MDF laminate work surface measuring 80x60x2,5cm for easy mobility when working. This free standing table sits at a comfortable height of 90cm on solid high gauge steel legs and weighs 26,5 kg.

The plate is already pre-bored for CMT routers CMT7E but is adaptable to all brands and models of routers on the market. Plate can also fit any router bit up to 98mm in diameter. Choose from our wide range of bits, including multi profile and molding bits or even kitchen bit set. Work easily and safely on this table!



TOOLBOX
 Dabagaldi & Instrumenti
www.TOOLBOX.lv info@toolbox.lv

Optional
999.100.11
 (mandatory for CE legislation)

order separately

DESCRIPTION	ORDER NO.
CMT professional router table system:	999.110.00
Electric safety switch (mandatory for CE legislation)	999.100.11
CMT7E router and 999.110.00 Professional router table + 999.100.11 Electric safety switch	CMT7E-PRO
Parts included with the table:	
1) Plate (pre-bored for CMT7E) with reduction rings	999.110.33
2) Lexan® safety shield	999.110.06
3) Standing spring press	999.110.08
4) Moulded ABS feather board	999.110.09
5) Transversal mitre gauge	999.110.10
Optional:	
Plate with 2 reduction rings not bored (not for CMT routers)	999.110.03

Industrio Routing System

CE Approved

CMT ORANGE TOOLS

999.500.01

CMT has turned the Industrio routing system into a great tool with new accessories such as a phenolic insert, integral aluminium scales and an improved fence. Also, you will find some new optional features, such as a rugged moulded featherboard and a new mitre gauge.

The system includes:
999.501.09

Phenolic router table insert plate
Measuring 298x374mm (11-3/4"x14-3/4"), the phenolic insert plate is 12mm thick and is far more sturdy and resistant to wear and warping than regular melamine surfaces. The top also features new aluminium scales on both ends for quick and easy fence setup.

Fast & Easy Bit Change

No need to remove the router or fumble beneath the table top to change the bits. CMT's useful bent wrench allows you to replace the bits from above quickly and easily. 15 kg. shipping weight.

999.501.10

Pivoting, zero-clearance fence with new clamping system.

Use the extruded aluminium fence either as a conventional lock-in-place fence or as a pivoting fence. Quick adjusting clamps on both ends make adjustments a breeze especially when used with the aluminium scales featured on the table top. The replaceable centre section on the fence creates zero-clearance inserts and features a sub-fence made of high density white plastic which guarantees an ultra smooth feeding surface. 8.5kg shipping weight.

999.501.03

Sturdy Melamine Cabinet

Made of 20mm thick melamine, this cabinet is easy to assemble thanks to easy-to-fit screws and cross-dowels. A double-door storage compartment means your tools stay safe and dust-free. 32.5kg shipping weight.

Router table dimensions:
79x59x(h)93cm. - 55 kg. weight

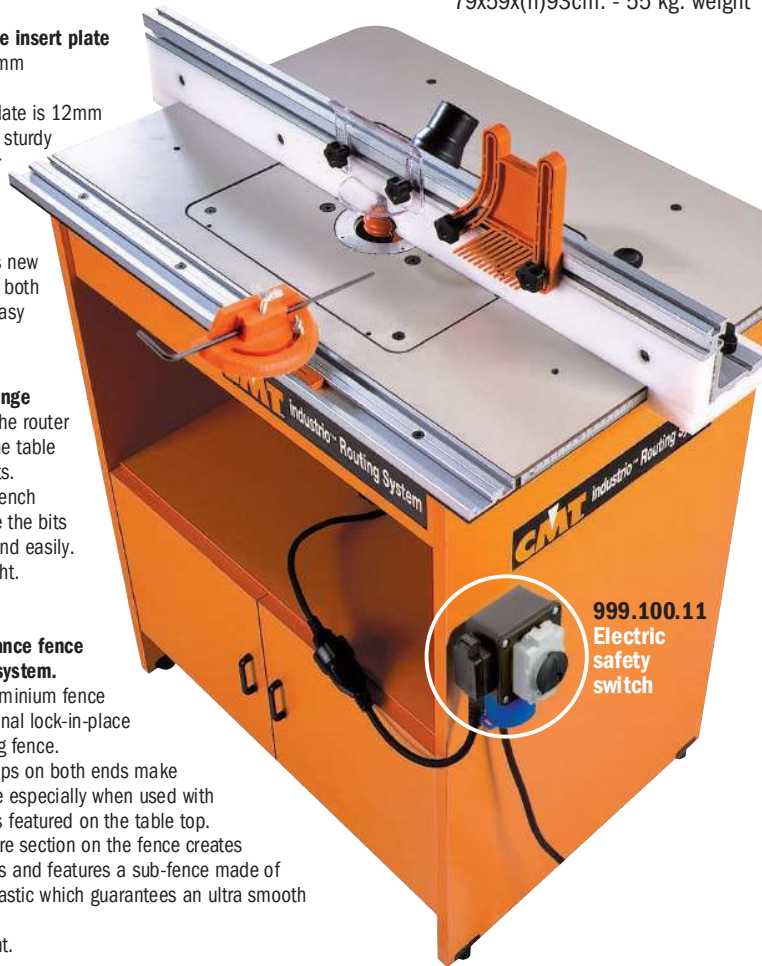

999.501.07 Moulded ABS featherboard setup on table and in fence slots. Includes nuts, bolts and a plastic slide.



999.501.08 Mitre gauge.



999.501.18 Phenolic plate with aluminium rings (Ø103-69,5mm) for CMT7E.



999.502.34 Centering device to perfect router positioning in the 8-12mm (5/16"-15/32") insert plate.



999.100.11 Electric safety switch



Watch the video on **YouTube**

Optional

Bent wrenches for easy bit replacement

- 17mm991.005.00
- 21mm991.002.00
- 22,2mm991.004.00
- 23,8mm991.003.00
- 24mm991.006.00***
- 28,6mm991.001.00

* For CMT7E and CMT8E routers



999.502.10 Central section of the fence is removable for custom replacements.



999.501.06 The dual and post-guard makes freehand work safer.

DESCRIPTION	ORDER NO.
Industrio routing system (with prebored plate for CMT7E)	999.500.01
CMT7E router and 999.500.01 Industrio routing system + 999.100.11 Electric safety switch	CMT7E-IND
Electric safety switch (mandatory for CE legislation)	999.100.11
Optional:	
Universal phenolic plate with aluminium rings (Ø103-69,5mm), not bored (not for CMT routers)	999.501.26
Phenolic plate with (Ø103-69,5mm) aluminium rings for CMT8E router	999.501.27
Pair of (Ø103-69,5mm) reduction rings	999.501.05N

Pocket-Pro™ Joinery System



PPJ-002

For fast, easy and accurate cabinet & furniture construction. Designed by CMT and professional cabinetmakers, this new system allows you to make rock-solid pocket hole joints in stock 12,7mm (1/2") to 41,3mm (1-5/8") thick with unprecedented speed and accuracy.

The heart of the Pocket-Pro™ system is our unique moulded jig, which features hardened drill bushings and an interlocking two-piece design. Sliding the jig up or down enables you to adjust the stock thickness in preset 1,6mm (1/16") increments without test joints or measurements! If you have used other pocket hole jigs you will be familiar with many joint applications, but you will benefit from many Pocket-Pro™ system advantages.

For example:

- some jigs require adding or removing various parts of the jig to join different stock thicknesses. With the Pocket-Pro™ system you simply have to adjust the interlocking jig up or down for the full range of joints 12,7mm (1/2") to 41,3mm (1-5/8") thick;
- other jigs require frequent repositioning of the depth stop collar for different joint styles. CMT's Pocket-Pro™ joinery system allows you to make most of the adjustments leaving the stop collar in the same position of the drill bit;
- plus, with CMT's Pocket-Pro™ system you can quickly adjust the location of the pocket in relation to the end of your workpiece to create a stronger joint by using longer screws, or to leave more "meat" in the joint.

Check out the Pocket-Pro™ joinery system today. Easy enough for beginners and accurate enough for professional workers, it is the world's most versatile pocket hole jig.



541.095.00 + 515.001.51



999.505.05



999.505.10



990.101X30



999.505.08

DESCRIPTION OPTIONAL	ORDER NO.
500 fine screws L=31,7mm (1-1/4")	990.101X500
500 coarse screws L=31,7mm (1-1/4")	990.102X500
500 fine screws L=38,1mm (1-1/2")	990.103X500
500 coarse screws L=38,1mm (1-1/2")	990.104X500
Face clamp swivel pad	999.505.06
L=76mm (3") square drive screwdriver bit	999.505.07
Phenolic insert plate (for Pocket Pro™)	999.505.04

DESCRIPTION	ORDER NO.
Pocket-Pro™ joinery system set	PPJ-002
Set contains:	
Pocket-Pro™ main parts	999.505.10
Toggle clamp	999.505.05
Ø9,5mm (3/8") step drill bit	515.001.51
Ø9,5mm (3/8") depth collar for step drill bit	541.095.00
L=152mm (6") Square drive screw driver bit	999.505.08
Masterpack 30 screw L=31,7mm (1-1/4")	990.101X30

Optional



999.505.04
Phenolic insert plate (for Pocket Pro™)



999.505.06
Face clamp with swivel pad

TOOLBOX

Darbagacki & Instrumenti
www.TOOLBOX.lv info@toolbox.lv

Enjoy Easy Pocket Hole Joinery!

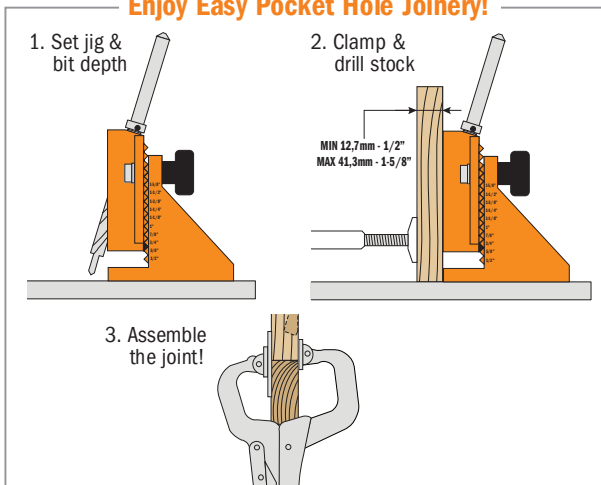

Build almost anything!

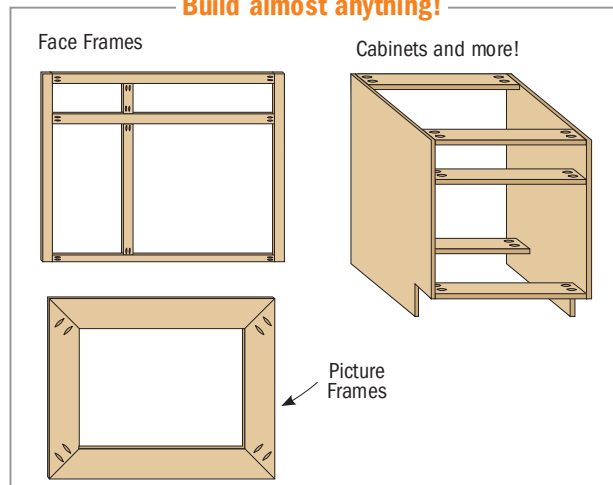

Small Stock Holder

PTC-1

By far, handling small stock on your router table is probably one of the most difficult challenges any professional woodworker has to face! Keeping all ten fingers attached to your hands is definitely a priority. This is why the CMT Small Stock Holder is an absolute necessity in the workshop! It safely ensures proper stabilization of smaller work pieces throughout the routing process. The handle grips fitted with comfy silicone inserts keep fingers and hands a safe distance from the blade while the anti-slip lining on both the center and right side base prevents slippage and ensures your workpiece stays put! Fully adjustable and easy to control, the CMT Small Stock Holder can manage small stock up to 216mm. (8-1/2") in width. The perfect little jig for detail-oriented jobs!

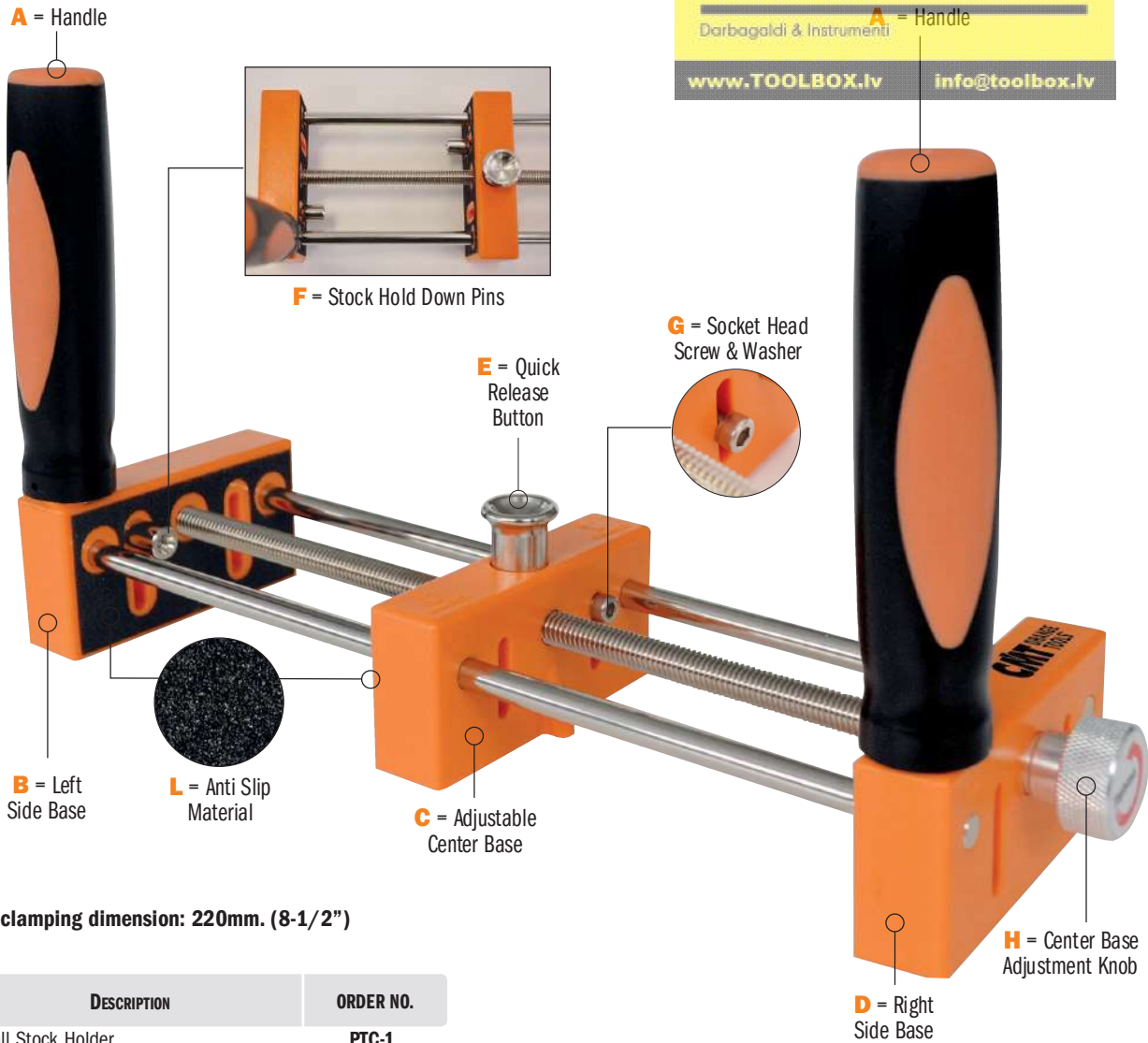
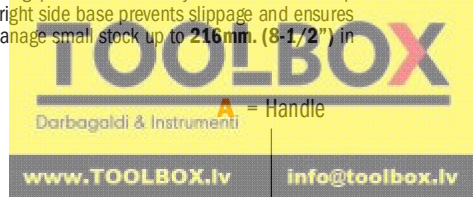

Max clamping dimension: 220mm. (8-1/2")

DESCRIPTION	ORDER NO.
Small Stock Holder	PTC-1

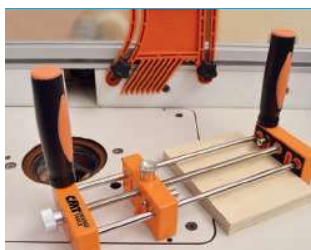

1. Lie the Small Stock Holder flat on the work surface. Slide the Hold Down Pins [F] to the top of the slotted holes. Insert the small stock piece between the Adjustable Centre [C] and Left-Side Bases [B]. The end of your small stock piece should lie flat and snug up against the Left-Side Base. The end must also extend outwards in front of the Small Stock Holder a minimum distance of half the diameter of the router bit in use.



2. Press the Quick Release Button [E]. Slide the Adjustable Centre Base [C] over until it fits snugly against the small stock piece. Release the Quick Release Button. In the image, a "sacrificial piece" is being used to prevent "tear-out". Loosen Hold Down Pins [F] with the Hex Key Wrench provided. Slide Hold Down Pins down until resting firmly against the small stock piece. Tighten pins with Hex Wrench. Rotate Centre Base Knob [H] to further secure your small stock piece.

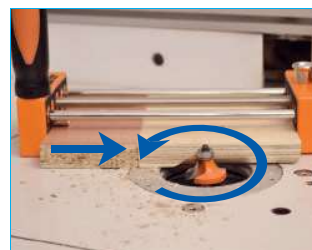

3. Adjust the height of your router bit. When you're ready, power on your router. Take hold of the Small Stock Holder Handles [A], slowly feed your small stock piece into the router opposite to the router bit rotation and always in contact with the router bit bearing guide. When finished routing, press the Quick Release Button [E] and slide the Adjustable Centre Base [C] over so you can remove the small stock piece.

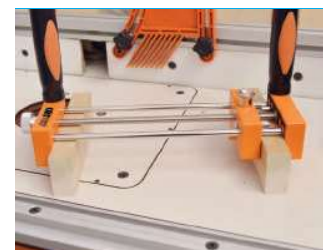

4. Need to rout stock thicker than the Small Stock Holder? Follow setup instructions carefully. Create an "outrigger" - cut a piece of stock, which will act as a stabilizer, the same thickness as the piece you are working on. Attach the "outrigger" securely to the Right-Side Base [D] using pan-head screws (not included) that will fit through the slotted holes. In this way, your work piece and the Small Stock Holder will remain stable during the routing process.

Professional Straight Edge Clamps

Used as a fence for your bandsaw, drill press or even as an auxiliary fence on your router table or table saw, CMT's professional straight edge clamps represent a two-in-one tool, allowing you to either use them as an edge guide, or to easily clamp your boards or any object for woodworking. Available in different sizes. Here are the main features:

- Made of extruded aluminium for easy carriage and enhanced durability.
- Light, yet more rigid than any other clamps on the market.
- Measuring scales, low-profile jaws, built-in T-tracks on the top allowing the use of accessories or jigs.
- Either single or back-to-back clamps.

DESCRIPTION	ORDER NO.
Professional Straight Edge Clamp 610mm	PGC-24
Professional Straight Edge Clamp 915mm	PGC-36
Professional Straight Edge Clamp 1270mm	PGC-50

Low-profile clamps allow for accurate cuts, dados and grooves. In addition they properly work as an auxiliary fence on your drill press or router table. Sturdy jaws hold your workpiece to the full length of the clamp without any side-to-side play. Back-to-back clamps with the suitable accessories also let you manage your woodworking operations with a lot of versatility. Adjustable scale and two T-tracks allow you to use many accessories.

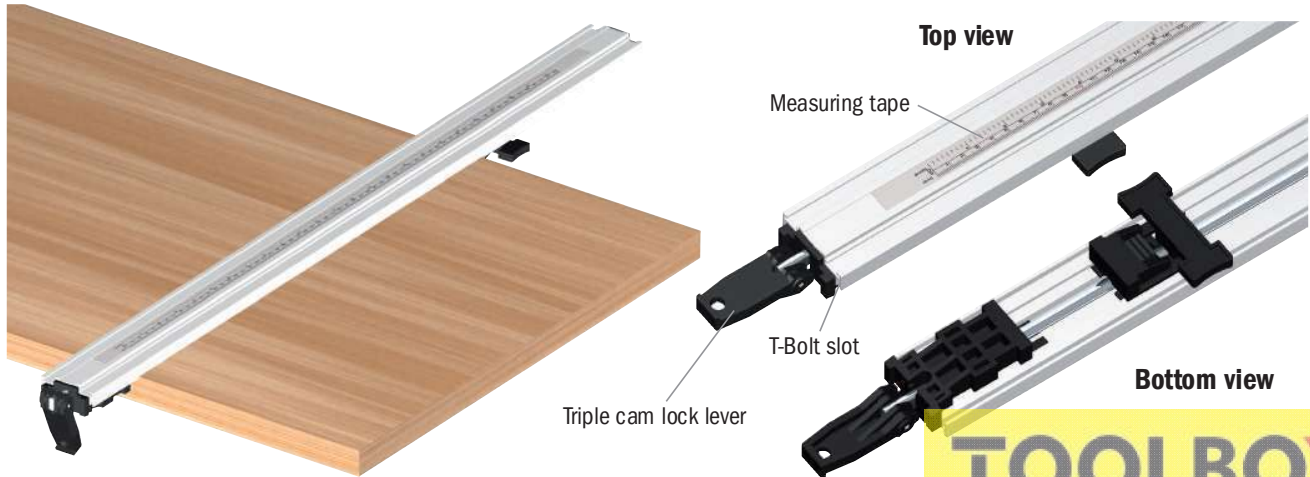

Back-to-Back Connectors for Straight Edge Clamps (optional)

Lay two more straight edge clamps on the back of the other pair of straight edge clamps and secure them by using your back-to-back connectors. Fasten the bottom jaw pads to the table top and clamp wood with the top jaw pads. Thanks to the low profile jaws your work surface is never obstructed. The back-to-back straight edge clamps can also be taken apart for making two separate clamps.

DESCRIPTION	ORDER NO.
Back to Back Connectors for straight edge clamps (8-Pieces)	PGC-B2B

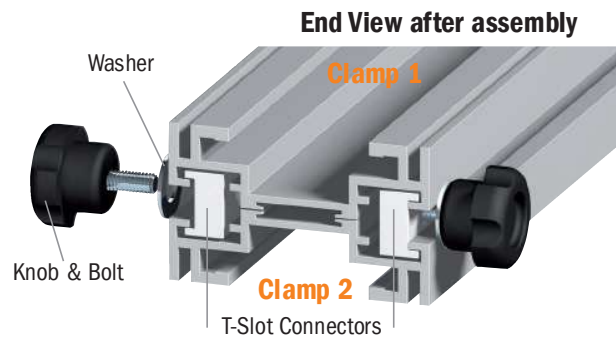

Adjustable Precision Router Dado Jig



PGD-1

The perfect tool for crafting grooves, dados, and joints. Easy to use and fully adjustable. You can create dados of any size using the same router by simply increasing the number of passes you make. Sturdy construction built to last. Smooth rolling steel rollers are ideal for easy maneuverability and stress-free handling. Compatible with almost any router equipped with 1-3/16" (30mm) bushings or by using the Bushing Template Guides included. (bore baseplate sold separately). Guarantees clean precise dados.

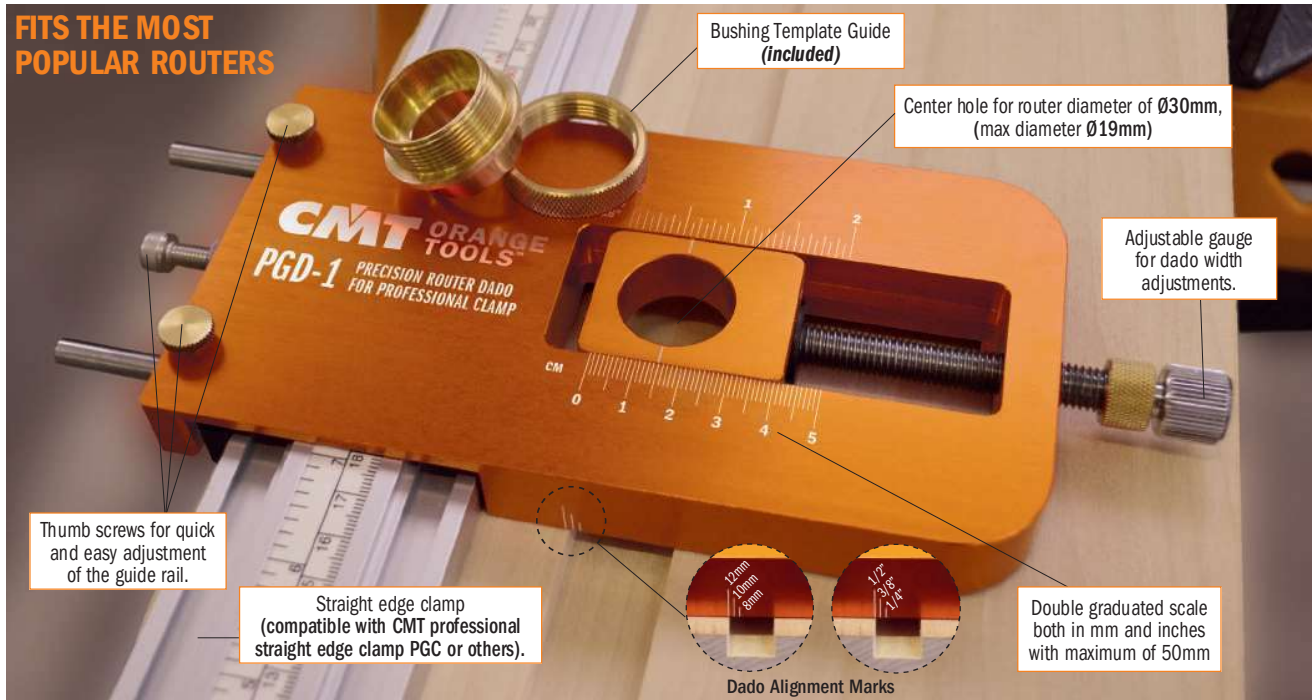

Prepare your router: Install the guide bushing rings into the bore baseplate and then attach it as the base for your router. Select and insert your router bit.

Prepare the Adjustable Guide Rail & Straight Edge Clamp: Position both the adjustable straight edge clamp and then the adjustable precision router dado jig onto your workpiece. Then using the adjustable thumb screws, secure it. Once assembled, ensure that the adjustable precision dado jig slides freely.



Insert your router into the center hole of the adjustable precision router dado jig.



Set your cutting depth by raising or lowering the bit until desired depth is reached. Determine the starting point of the cut you wish to make by using the Dado Alignment Marks on the long sides (width) of the Adjustable Precision Router Dado Jig which indicates the outside edge of the dado cut closest to the straight edge clamp (12-10-8mm front, 1/2", 3/8", 1/4" back).



Holding onto your router in position, power on and begin making the cut by pushing forward and back on the straight edge clamp using the precision router dado jig as a guide. Makes impeccable grooves and dados along the length of your workpiece.



For creating dados that exceed router width, using the adjustable gauge, simply select the desired width on the graduated scale.

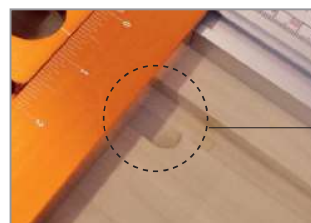

Make as many passes necessary to obtain the desired dado width.

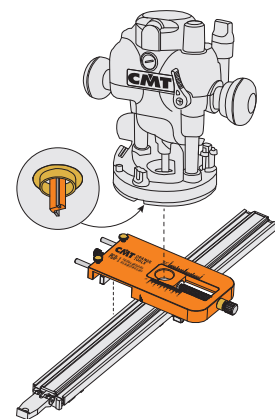
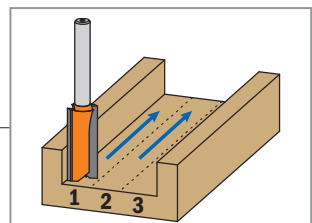

RECOMMENDED* (not included)

Universal Router Base

899.000.01 or

899.000.02 Prebored base for CMT7E/CMT8E

*Not required for routers with 1-3/16" bushing guide



RECOMMENDED (not included)

PGC Straight Edge Clamp with graduated scale (pag. 342)

DESCRIPTION	QUANTITY	ORDER NO.
Adjustable Precision Router Dado Jig	10	PGD-1

Universal Dovetail Jig



CMT300

305mm max length
11~25mm joint thickness

Dovetail joints give a touch of craftsmanship to your work, but many woodworkers avoid these joints, because of their apparent complexity. CMT's new 305mm dovetail jig is the fast easy solution! Thanks to precise templates, permanent stops and easy adjustments, we have taken the "tinkering" out of dovetail joinery. Simply clamp your workpiece in with the edges against the factory-set stops, set your bit depth and then you are ready to rout. Rest assured, we haven't cut corners on quality either. This jig features a rugged steel body, templates, stops and clamping bars that together produce perfect long-lasting joints for all your woodworking needs. The jig accepts stock from 11mm to 25mm in thickness and is capable of crafting a variety of joints with the available templates. The jig comes with a template for 12.7mm half blind joints as well as a template guide. Optional templates are available for through dovetail and box joints.



Standard equipment

- Standard Ø12,7mm silver blind template **CMT300-T128**
- Ø15,8x4mm template guide **899.005.00**

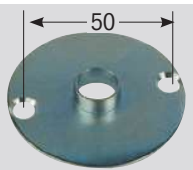

DESCRIPTION	ORDER NO.
Universal Dovetail Jig	CMT300

IMPORTANT TIP



HW DOVETAIL BITS (not included):

- | | | | |
|-------------------|----------|-------|----------|
| 718.127.11 | D=12,7mm | A=14° | S=6mm |
| 818.128.11 | D=12,7mm | A=14° | S=6,35mm |
| 918.127.11 | D=12,7mm | A=14° | S=8mm |
| 818.628.11 | D=12,7mm | A=14° | S=12,7mm |



Will the template fit my router?

Standard template guide attaches using two screws spaced 50mm on centre. Many routers are compatible with this design. However, if yours is not, choose from the list of universal router bases here below:

Universal router bases

- For Ø8 and Ø12mm shank
- For Ø6,35 and Ø12,7mm shank
- Prebored router plate for CMT7E and CMT8E

ORDER NO.

- CMT300-SB1**
- CMT300-SB2**
- CMT300-SB**

Here's how it works:

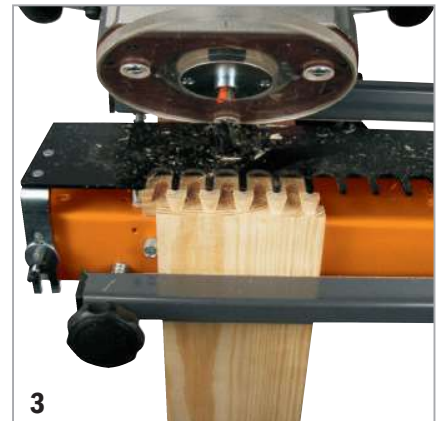

Half Blind Template **CMT300-T064**



TEMPLATE LENGTH mm	DOVETAIL SIZE mm	THICKNESS mm	COLOUR	ORDER NO.
300	6,3	8 ~ 12	green	CMT300-T064

Supplied with Ø7,8x4mm precision guide

To be used with CMT dovetail router bits:
 Ø6x8mm HW bit (Ø6mm shank)
 Ø6,35x8,3mm HW bit (Ø6,35mm shank)



899.003.00

718.060.11

818.064.11

Through Dovetail Templates **CMT300-T129 - CMT300-T190**

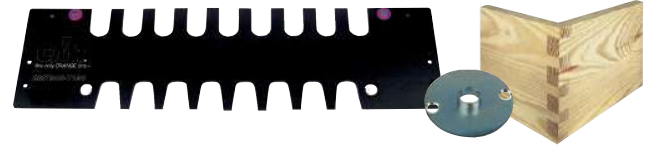

TEMPLATE LENGTH mm	DOVETAIL SIZE mm	THICKNESS mm	COLOUR	ORDER NO.
300	12,7	8 ~ 20	brown	CMT300-T129

Supplied with Ø11,1x4mm precision guide

To be used with CMT straight router bits:
 Ø8x25mm HW bit (shank Ø6,35mm)
 Ø8x30mm HW bit (shank Ø8mm)



899.004.00

811.081.11

912.080.11

To be used with CMT dovetail router bits:
 Ø12,7x20mm HW bit (Ø6,3mm shank)
 Ø12,7x20mm HW bit (Ø8mm shank)

818.129.11

918.129.11

Box Joint Templates **CMT300-T080 - CMT300-T127**

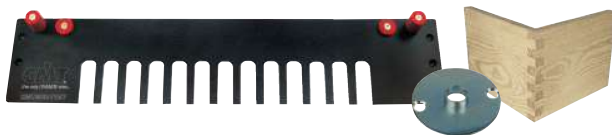

TEMPLATE LENGTH mm	DOVETAIL SIZE mm	THICKNESS mm	COLOUR	ORDER NO.
300	8	8 ~ 20	blue	CMT300-T080

Supplied with Ø11,1x4mm precision guide

To be used with CMT straight router bits:
 Ø8x25mm HW bit (Ø6,35mm shank)
 Ø8x30mm HW bit (Ø8mm shank)



899.004.00

811.081.11

912.080.11

TEMPLATE LENGTH mm	DOVETAIL SIZE mm	THICKNESS mm	COLOUR	ORDER NO.
300	12,7	8 ~ 20	red	CMT300-T127

To be used with CMT straight router bits:
 Ø12,7x30mm bit HW (Ø6,35mm shank)
 Ø12,7x30mm bit HW (Ø8mm shank)
 Ø12,7x25mm bit HW (Ø12,7mm shank)



812.127.11

912.127.11

811.627.11

TEMPLATE LENGTH mm	DOVETAIL SIZE mm	THICKNESS mm	COLOUR	ORDER NO.
300	19	15 ~ 22	violet	CMT300-T190

Supplied with Ø22x4mm precision guide

To be used with CMT straight router bits:
 Ø12,7x30mm HW bit (Ø6,35mm shank)
 Ø12,7x30mm HW bit (Ø8mm shank)
 Ø12,7x25mm HW bit (Ø12,7mm shank)



899.006.00

812.127.11

912.127.11

811.627.11

To be used with CMT dovetail router bits:
 Ø19x22mm HW bit (Ø6mm shank)
 Ø19x22mm HW bit (Ø6,35mm shank)
 Ø19x22mm HW bit (Ø8mm shank)
 Ø19x22mm HW bit (Ø12mm shank)
 Ø19x22mm HW bit (Ø12,7mm shank)

718.190.11

818.190.11

918.190.11

918.690.11

818.690.11

Precision guide for router:

DIAMETER	ORDER NO.
7,8 x 4mm	899.003.00
11,1 x 4mm	899.004.00
15,8 x 4mm	899.005.00
22 x 4mm	899.006.00
27 x 6mm	899.008.00
30 x 6mm	899.007.00

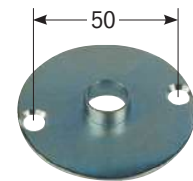

TOOLBOX

Darbagaldi & Instrumenti

Here are a few of the beautiful dovetail joints you can produce using CMT bits

Half blind

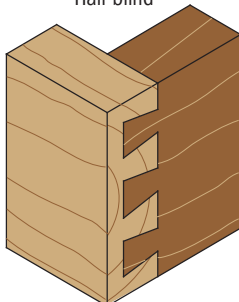

CMT300 - T064
CMT300 - T128 (INCLUDED with CMT300)

Box joint

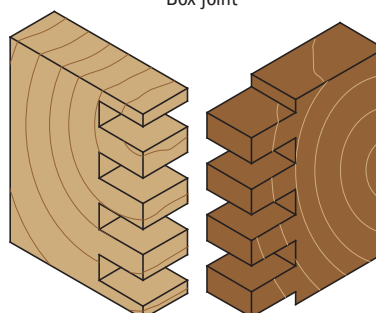

CMT300 - T080
CMT300 - T127

Through dovetail

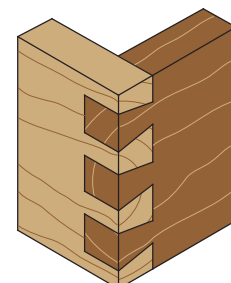

CMT300 - T129
CMT300 - T190

Ellipse & Circle Cutting Jig

TOOLBOX

Darbagaldi & Instrumenti

www.TOOLBOX.lv

info@toolbox.lv



CMT3000

This product has been designed for cutting ellipses and circles with any type of router. You can make ellipses and circles for windows, doors and any other application. By using two slides into the T-slot you can cut ellipses, whereas if you use one slide, you can cut circles.

CMT3000 ellipse jig includes:

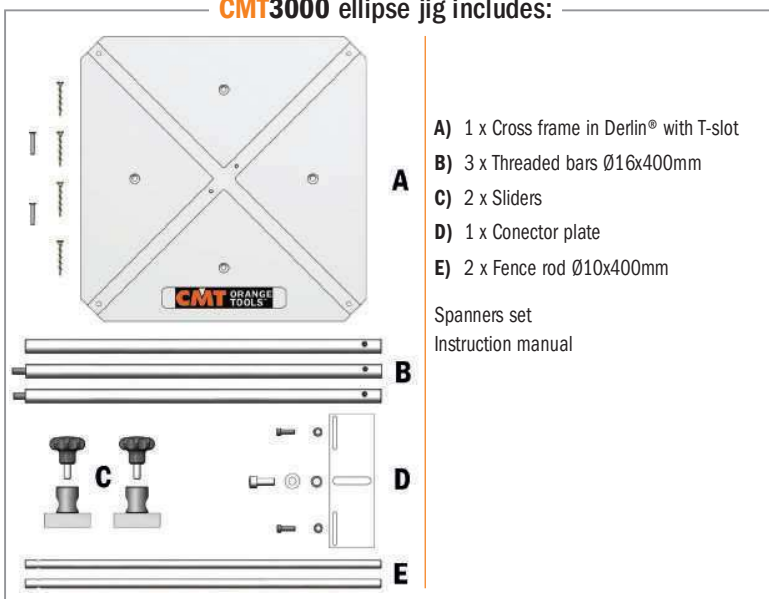

- A) 1 x Cross frame in Delrin® with T-slot
- B) 3 x Threaded bars Ø16x400mm
- C) 2 x Sliders
- D) 1 x Connector plate
- E) 2 x Fence rod Ø10x400mm

Spanners set
Instruction manual



Slider in the T-slot of the cross frame

Ellipse and circle cutting jig:

- Precise and rapid creation of ellipses and circles.
- Simple setup and effective operating.
- Clamping system for any type of routers.
- Special plastic cross frame with excellent sliding performance.
- Precisely machined T-slots and steel sliders.
- Zinc-coated metal parts to prevent rust.
- Delivered in a carton box along with instruction manual.

Major axis	Minor axes	
	Max	Min.
3000	2890	2590
1800	1690	1390
1500*	1390	1090
1030	920	620
900	790	620
730	620	620
*Min/Max radius routing with standard equipment		550/1500
Package dimension (mm)		445x360x85
Weight		6 kg.

Here are a few examples you can create using CMT3000 Ellipse

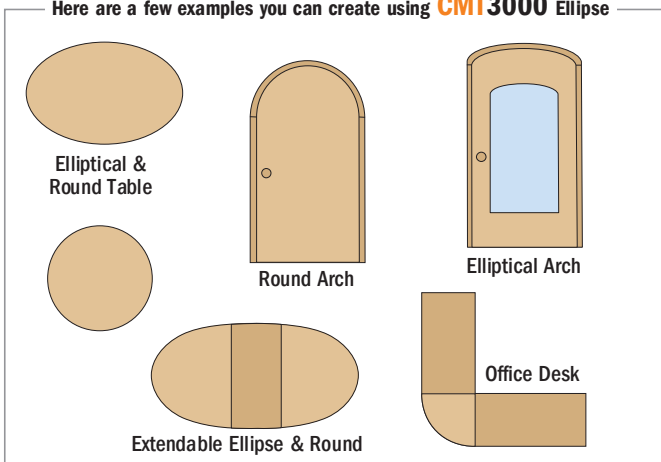

Optional



CMT3000-SB1

Ø170x15mm Delrin® guide plate for CMT3000 to be used with CMT7E & CMT8E

DESCRIPTION	ORDER NO.
Ellipse & Circle Cutting Jig	CMT3000
Optional:	
400mm robust bar to extend the working radius	CMT3000-7
2-Pcs. of fence rod for routers with bars up to Ø8mm in diameter	CMT3000-8
Ø170x15mm Delrin® guide plate for CMT3000 to be used with CMT7E & CMT8E	CMT3000-SB1



Dimensions:
880x300x 10mm.

CMT650

For perfect joints

For kitchen worktops from 420mm to 650mm in width.

CMT650 is designed to cut kitchen worktop joints with any type of router.

Letter code system for different operations makes the jig work much easier and very quick.



Joints made in 15 minutes! Including setup time

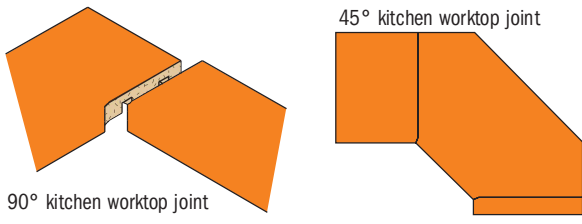

JIG INCLUDES:

- 1pc. Phenolic template
- 3pc. Zinc-coated steel location bush
- 1pc. Adjustable end stop
- 1pc. Instruction manual

TOOLBOX

Barbieri & Instrumenti

www.TOOLBOX.lv

info@toolbox.lv

Optional

- Portable router
- HW straight bit Ø12mm
- Guide bush Ø30mm*
- Two clamps

* COMBINATION ROUTERS/ACCESSORIES

Router	Bush guide	Base Plate
CMT7E	899.007.00	CMT300-SB
CMT8E	899.007.00	CMT300-SB
NO-CMT	899.007.00	CMT300-SB1



Bush guide



Base plate



652



8/912

Bits for the jig:

We recommend the use of these Ø12mm straight bits:

ORDER NO.	DESCRIPTION
912.120.11	Ø12x31,7 S=8mm
652.120.11	Ø12x28,3 S=8mm
912.621.11	Ø12x38,1 S=12mm
912.622.11	Ø12x50,8 S=12mm
812.620.11	Ø12x31,7 S=12,7mm
812.621.11	Ø12x38,1 S=12,7mm
652.121.11	Ø12x48,3 S=12mm
652.621.11	Ø12x48,3 S=12,7mm

CMT650 is designed for Ø12mm straight bits.

- Template made of stable and hardened material.
- For 90° and 45° joints
- Integrated templates for rounding over and chamfering edges.
- Extra location bush for worktop width of 600mm.
- Two integrated templates for panel bolt recesses.
- Delivered with a clear and comprehensive instruction manual.

DESCRIPTION	ORDER NO.
Kitchen Worktop Jig	CMT650

Universal Hinges Boring System



The innovative CMT333 hinge boring system with 3 spindle-heads allows you to bore holes for any hinge brand. The universal modular base supports the installation of many boring heads, engineered by the worldwide leading company in industrial boring machines. Use the CMT333 universal hinge boring system on all hand-held or standing drilling power tools.

CMT333



COMPATIBLE WITH MANY HINGE TYPES

Ø8mm/hexagonal shank suitable for any drilling machine



BORING HEAD NOT INCLUDED
Choose from one of these options:

- CMT333-4211
- CMT333-4595
- CMT333-4809
- CMT333-4300
- CMT333-4806
- CMT333-5255
- CMT333-3875
- CMT333-325



For use on standing drilling machines



To use on standing drilling power tools



For use on CMT Industrio router table

Universal Hinges Boring System

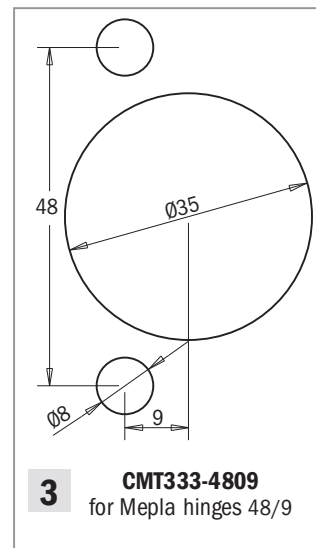
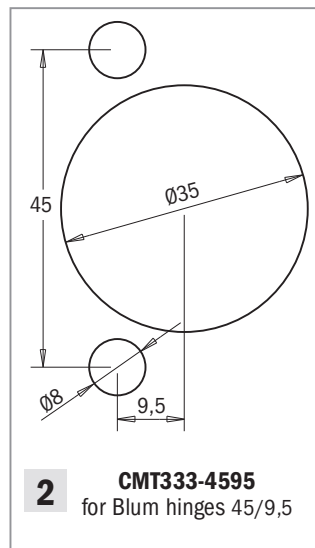
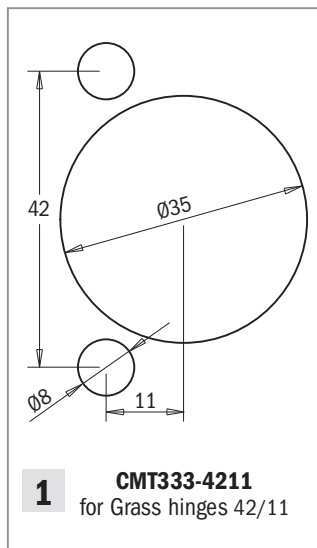

TECHNICAL FEATURES AND SPECIFICATIONS

- Complete anti-rust parts
- Ground aluminium (Avional)
- Max 5000 RPM
- Six radial antifriction bearings

SAFETY TIPS:

for lubrication use oil SHC100 Mobil

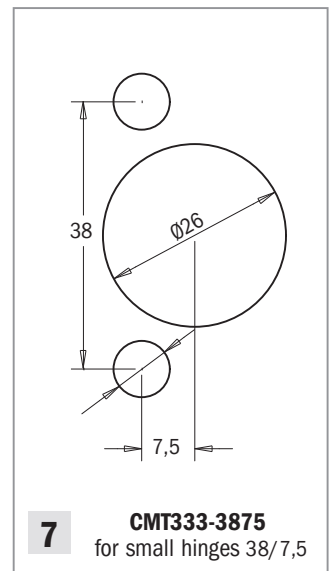
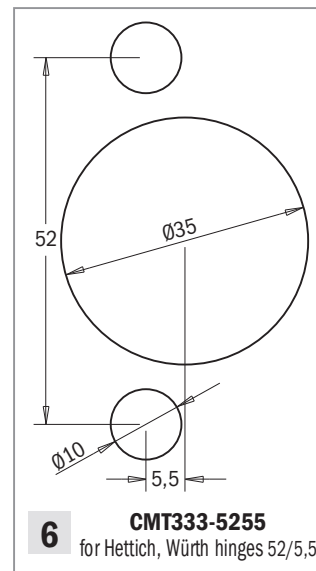
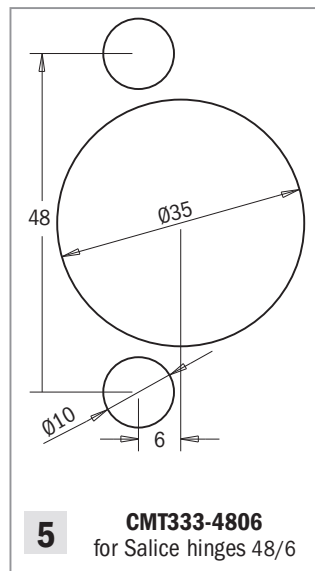
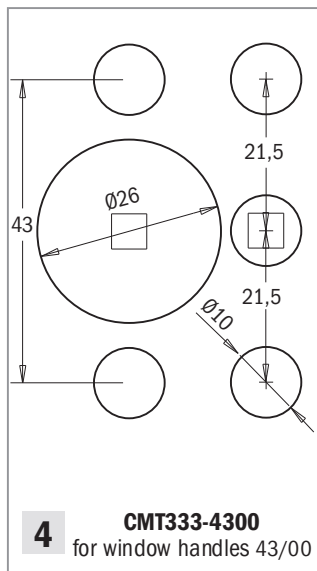

MAXIMUM VERSATILITY FOR ANY BRAND

Support modular base	Boring heads	Drill bits	Boring bit	Make your set
ORDER NO.	ORDER NO.	S	ORDER NO. Left-hand rotation	ORDER NO. Right-hand rotation
CMT333	CMT333-4211	8mm	310.080.12 (2 pcs.)	317.350.11
CMT333	CMT333-4595	Hexagonal	310.080.12 (2 pcs.)	317.350.11
CMT333	CMT333-4809	8mm	310.080.12 (2 pcs.)	317.350.11
CMT333	CMT333-4300	Hexagonal	310.100.12 (2 pcs.)	317.260.11
CMT333	CMT333-4806	8mm	310.100.12 (2 pcs.)	317.350.11
CMT333	CMT333-5255	Hexagonal	310.100.12 (2 pcs.)	317.350.11
CMT333	CMT333-3875	8mm	310 your choice (2 pcs.)	317.260.11
CMT333	CMT333-325	Hexagonal	(3 pcs. RH + 2 pcs. LH)	

Choose your hinge	
1 Grass	42/11
2 Blum	45/9,5
3 Mepla	48/9
4 Window handles	43/00
5 Salice	48/6
6 Hettich, Würth	52/5,5
7 Small hinges	38/7,5
8 System 32	32

Boring head System 32

The universal modular base supports the installation of the System 32 with 5 adapters, engineered by the worldwide leading company in industrial boring machines. Use the CMT333 universal hinge boring system on all hand-held or standing drilling power tools.

CMT333-325

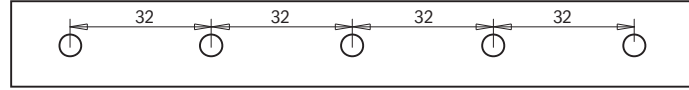

DESCRIPTION	ORDER NO.
Boring head with 5 adapters for system 32	CMT333-325

Blum Hinges Boring Head

The innovative CMT334 Universal Hinge Boring Head features three spindles which allow you to bore the holes for all of the major hinge brands. The head can be utilized on boring and point to point machines.

CMT334

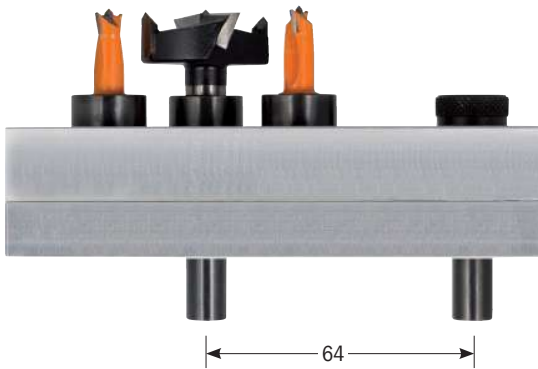

For use on boring and point to point machines.

Standard

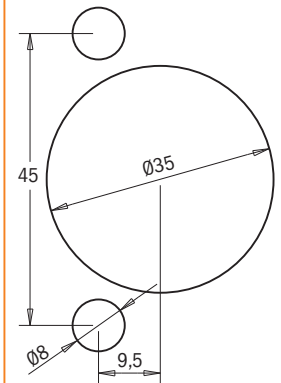

DESCRIPTION	ORDER NO.
Hinge Boring Head (bits not included)	CMT334-4595
Boring Bit Ø35mm x 38,5mm. Right-hand rotation	393.350.11
Dowel Drill Ø8mm x 38,5mm. Left-hand rotation	393.080.12

CMT334-4595
for Blum hinges 45/9.5

Bench Block Set

These blocks are great for holding your workpiece without any clamps. Their anti-slip surface grip both your bench top and the underside of your workpiece. Raise your work above the bench and benefit from plenty of clearance for your router bits, cutters, etc.

Length: 75mm
Width: 50mm
Height: 25mm

BBS-001



DESCRIPTION	ORDER NO.
Bench block set (4-Pcs.) 75x50x25	BBS-001

CMT Inlay Kit

899

Beautiful, professional-quality inlays aren't as difficult as they seem. In fact, they are easy with the CMT inlay kit. Just remove and reassemble the small bushing to make the recess in the workpiece and cut out the inlay. Perfect for toy making, puzzle making, lettering and lots of other decorative projects. Use the spiral bit for routing MDF, or the straight bit for natural wood.

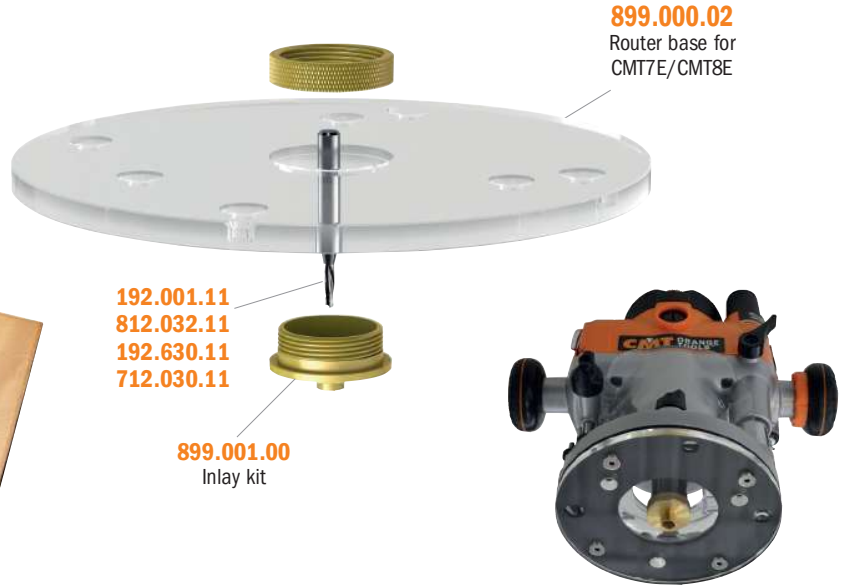

899.000.02
Router base for CMT7E/CMT8E

192.001.11
812.032.11
192.630.11
712.030.11

899.001.00
Inlay kit

Complete instructions for assembling and using CMT inlay kit are included.

DESCRIPTION	ORDER NO.
Inlay kit with 3,2mm (1/8") HWM spiral bit (Ø6,35mm shank)	899.051.00
Inlay kit with 3,2mm (1/8") HWM straight bit (Ø6,35mm shank)	899.052.00
Solid brass template guide	899.001.00
Universal router base	899.000.01
Router base for CMT7E/CMT8E	899.000.02
3,2mm (1/8") HWM spiral bit (Ø6,35mm shank)	192.001.11
3,2mm (1/8") HWM straight bit (Ø6,35mm shank)	812.032.11
3mm HWM spiral bit (Ø6mm shank)	192.630.11
3mm HWM straight bit (Ø6mm shank)	712.030.11

Template Guide Kit

A practical 7-bushing kit that will extend the possibilities of your router. For template-controlled operations such as dovetailing, stair routing, hinge butt routing, lock face routing and more general template tasks. These template guides can be used with any router featuring a 30mm (1-3/16") bore baseplate. Fits the most popular routers. Some routers require CMT's base 899.000.02.



CMT-TGA

Optional

DESCRIPTION	ORDER NO.
Prebored base for CMT7E and CMT8E	899.000.02
Universal base	899.000.01

DESCRIPTION	ORDER NO.
Template Guide Kit	CMT-TGA

Set contains:

QTY.	1	1	1	1	1	1	1	2	1
Internal diameter	15,87mm	16,66mm	13,49mm	10,31mm	8,73mm	7,14mm	6,35mm	Lock Nut	Adapter
Outside diameter	20,24mm	19,05mm	15,87mm	12,7mm	11,11mm	9,52mm	7,93mm	Lock Nut	
Height	14,28mm	14,28mm	14,28mm	7,93mm	3,96mm	7,93mm	3,96mm		

Universal Boring Template



CMT900

For dowelling into surfaces
and shelf supports
and hinges

CMT's universal boring template has been designed for precise and productive manual dowelling of furniture elements by using 32mm Euro-System screws, for boring shelf supports with 3mm or 5mm diameter and for making and marking hinge holes.

By using this template you can prebore the most popular hinge types and also to bore holes for pivots, wooden screws and hinges on the base element, as well as prebore door hinges, included the marking of holes featuring 35mm in diameter for hinges.

This template will guarantee high precision work and productivity and has been designed to be used in pair with the specific CMT400-1 boring adapter supporting any Ø8mm shank drill bits featuring different diametres.

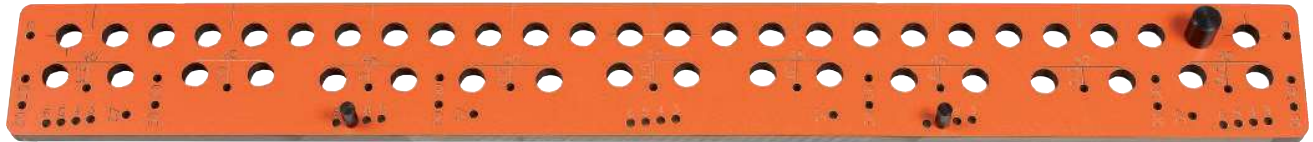

Laminated phenolic material

Clear and comprehensible template marking

Precise end stops



BORING ADAPTERS (not included):

- End stop for different boring depths
- Suitable for any type of drilling machine
- Duralumin body with holes for better chip ejection
- Precise and flat seating for proper alignment.

ORDER NO. **CMT400-1**

Boring adapter for **CMT656, CMT900 JIGS**

to be used with drill bits up to 30mm depth:

306.030.21 - 306.050.11 - 306.080.11



HW DOWEL BITS (not included):

DESCRIPTION	ORDER NO.
D=3x18mm S=8x20mm HWM	306.030.21
D=5x30mm S=8x20mm HW	306.050.11
D=8x30mm S=8x20mm HW	306.080.11

Other sizes available in 306-307 series

QUICK AND EASY:

TECHNICAL DETAILS:

	CMT900
Max. board width in one tightening:	900mm
Max board width:	no limits
Board thickness:	no limits
For dowels:	Ø8mm
Hole distance:	32mm
Number of holes:	26
For shelf support:	Ø3mm, Ø5mm
For hinges:	Ø3mm for wooden screws Ø5mm for Euro screws

TOOLBOX

Darbagaldi & Instrumenti

www.TOOLBOX.lv

info@toolbox.lv

Boring into a surface for dowel joints using the template.

Boring Ø3mm and Ø5mm holes for shelf supports.

Preboring holes for hinges (base and panel).



CMT900 Boring Template Includes:

- Boring template from laminated pertinax
- End stop set
- End stop set for large elements
- Centering pin for hinges

DESCRIPTION

ORDER NO.

Universal Boring Template

CMT900

Universal Boring Jig



This universal boring jig has been designed for precise and productive manual dowelling of furniture elements and guarantees high precision work and productivity. The holes have been made with a distance of 32mm between one another, in compliance with the European regulations for dowelling machine production. Also, the dowel jig fits CMT Ø8mm shank HW drill bits, clamped into a special boring adapter.

CMT656

Precise holes
Detachable end stops
Ergonomic manual tighteners
Precise and flat Duralumin profile

For edge dowelling and jointing



SPARE CLAMP (optional)

To speed up your work with elements of different width.
Order no. **CMT400-3**

UNIQUE SOLUTION

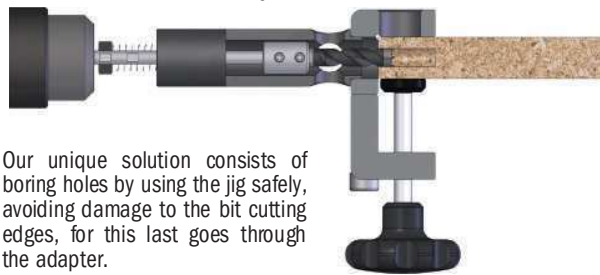

Our unique solution consists of boring holes by using the jig safely, avoiding damage to the bit cutting edges, for this last goes through the adapter.

BORING ADAPTERS (not included):

- End stop for different boring depths
- Suitable for any type of drilling machine
- Duralumin body with holes for better chip ejection
- Precise and flat seating for properly alignment.

ORDER NO. **CMT400-1**

Boring adapter for **CMT656, CMT900 JIGS**

to use with drills bit:

306.030.21 - 306.050.11 - 306.080.11 - 307.050.11

ORDER NO. **CMT400-2** (for screw joints)

Boring adapter for **CMT656, CMT900 JIGS**

to use with the drill bit: 307.050.11

3 easy steps in creating dowel joints



Place the jig onto the board, fix the end stop and tighten the workpiece. Set the bore depth and clamp the boring adapter on your drilling machine. Bore vertical holes.



Fasten the jig on the other element, fix the end stop and set the bore depth. Bore horizontal holes.



Now insert the dowels with glue into the holes and join both elements.



As an alternative, use through hole bits and screw the elements together.

HW DOWEL BITS (not included):

DESCRIPTION	ORDER NO.
D=3x18mm S=8x20mm HWM	306.030.21
D=5x30mm S=8x20mm HW	306.050.11
D=8x30mm S=8x20mm HW	306.080.11
D=5x40mm S=8x20mm HW	307.050.11 for screw joints
D=7x40mm S=8x20mm HW	307.070.11 for screw joints

Other sizes available in 306-307 series

TECHNICAL DETAILS: CMT656

Max board width in one tightening: 656mm
For dowels: Ø8mm
For through holes: Ø7mm
Hole distance: 32mm
Number of Ø18mm holes : 2x20
Board thickness: 16-40mm
Facet (elements lap): 0,8mm

DESCRIPTION	ORDER NO.
Universal Boring Jig (656mm in one tightening)	CMT656

3D Router Carver System



RCS

Exclusively from your CMT distributor

Turn your router into a remarkable carving tool. It's fast, easy, and a whole lot of fun!

Who says that intricate woodcarving requires an artist's touch? Thanks to the patented 3D Router Carver system, anyone with a plunge router can create any of the beautiful designs shown on these pages in just minutes. Decorate doors, drawers, cabinets, furniture or just about any flat wooden surface with one or more of these designs. How does it work? The secret is in the 3D Router Carver Bit and the way that bit interacts with the carving templates. The V-Groove router bit is enclosed in a 45° cone-shaped guide. You rout with the plunge mechanism of your router **unlocked**, allowing the bit to move up or down as the router moves forward. As the slot in the template get wider, the bit moves down, producing a wider, deeper V-groove. As the slot gets narrower, the bit moves up, and the groove gets narrower and shallower. It sounds simple, and it is! (that's why the system is patented worldwide). Please see the illustrations below for more details on the carving technique. You'll receive complete instructions with your 3D Carver templates. For an informative visual demonstration, check out the 3D Router Carver video on our web site.

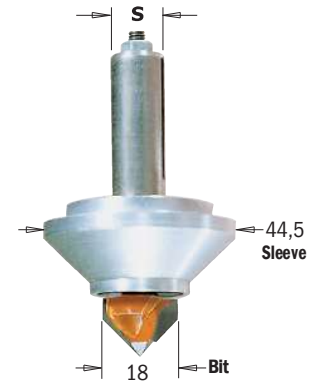







What do you need to get started?

- The 3D Router Carver bit
- The Carver template of your choice
- The Holding frame to match your template
- Your plunge router

(Note: Be sure the opening in the base of your router is at least 47.6mm in diameter. If it isn't, you'll need to make a sub-base to accept the large diameter of the 3D Carver bit.)



3D Router Carver Bit & Sleeve

S mm	ORDER NO. Right-hand rotation	Spare parts					Optional
8	RCS-BIT8	 RCS-CUT8	 RCS-SLE8	 RCS-SHIELD	 990.091.00	 990.092.00	 991.007.00
12,7	RCS-BIT	RCS-CUT	RCS-SLE	RCS-SHIELD	990.091.00	990.092.00	RCS-SLEEVE8 RCS-SLEEVE

Here's how it works:

1. Clamp or tack the holding frame to your workpiece

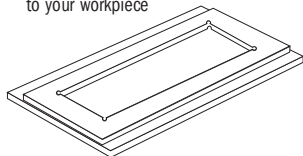

2. Drop the template into a

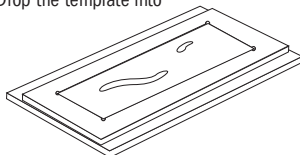

3. Plunge the bit into a wide part of the slot and rout with the router's plunge mechanism unlocked.

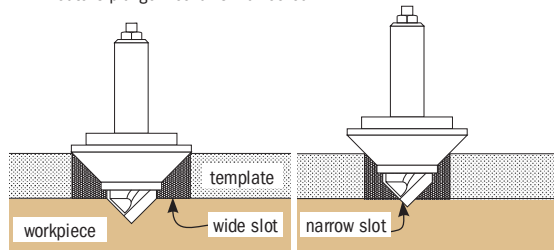

Allow the plunge mechanism to move up and down as you advance. Wider template slots allow wider, deeper grooves. Narrower slots produce shallower grooves.

4. With the frame still in place, flip the template & rout again. Some templates will be routed 2 to 4 times, depending on the complexity of the design.

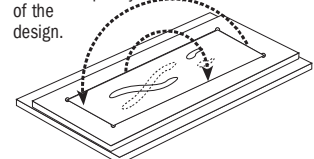

5. Remove the frame and you're finished!

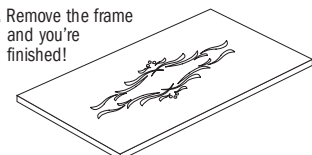

Cabinet door & panel carvings

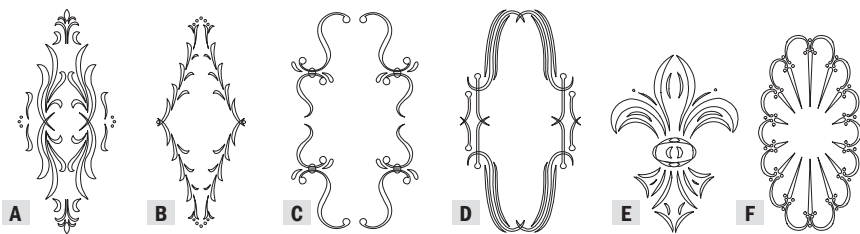

These designs are ideal for the doors or panels of cabinets, entertainment centers, fireplace surrounds or almost any flat surface. See the designs below for complementary patterns for drawers, rails and corners. Approximate carving time is 5 minutes.

DESCRIPTION	CARVING DIMENSIONS mm	NO. OF TEMPLATES	ORDER NO.
Classical cabinet door - A	440 x 185	2	RCS-302
Florentine cabinet door - B	415 x 170	2	RCS-304
Cascade cabinet door - C	365 x 210	1	RCS-305
Roma cabinet door - D	375 x 200	1	RCS-306
Fleur-de-Lys door - E	250 x 180	4	RCS-805
Spanish fan template - F	380 x 200	2	RCS-806
Cabinet door holding frame			RCS-003





Tip: many carvings, like the Florentine rail, are enhanced with the additional of a rosette.



Panel & Rail Carvings

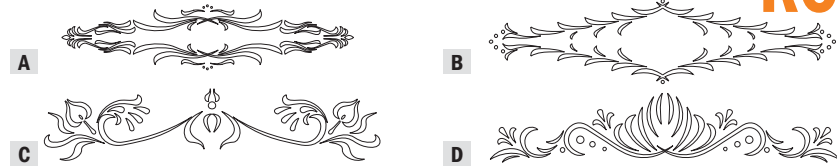

With a long, horizontal shape, these designs are perfect for door rails, headboards, cabinet face frames and valences. Approximate carving time is 4 minutes.

DESCRIPTION	CARVING DIMENSIONS mm	NO. OF TEMPLATES	ORDER NO.
Classical Rail - A	550 x 120	2	RCS-402
Florentine Rail - B	550 x 130	2	RCS-404
Cascade Rail - C	530 x 110	3	RCS-405
Folklore Rail - D	550 x 110	3	RCS-406
Rail Holding Frame			RCS-004

Drawer & Furniture Carvings

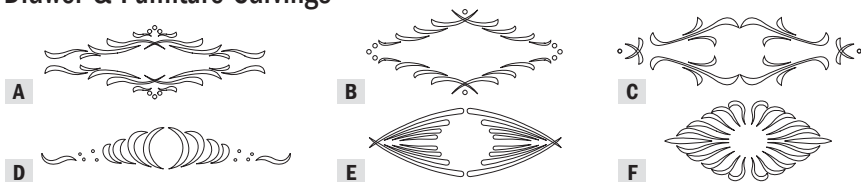

Originally intended for drawer fronts, these designs are great for lots of other projects: small doors, side panels of cabinets, furniture and more. For door and drawer combinations, match the style of the door designs above. Approximate carving time is 4 minutes.

DESCRIPTION	CARVING DIMENSIONS mm	NO. OF TEMPLATES	ORDER NO.
Classical Drawer - A	210 x 70	2	RCS-502
Florentine Drawer - B	195 x 85	2	RCS-504
Cascade Drawer - C	250 x 65	1	RCS-505
Folklore Drawer - D	250 x 40	2	RCS-506
Roma Drawer - E	190 x 65	2	RCS-507
Blaze Drawer - F	250 x 110	2	RCS-510
Drawer Holding Frame			RCS-005



Corner & Small Decoration Carving Designs



DESCRIPTION	CARVING DIMENSIONS mm	NO. OF TEMPLATES	ORDER NO.
Classical "A"	155 x 40	3	RCS-602
Florentine "B"	120 x 30	3	RCS-604
Cascade "C"	190 x 40	3	RCS-605
Folklore "D"	150 x 45	3	RCS-606
Corner Holding Frame			RCS-006

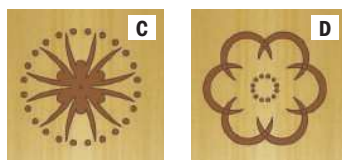
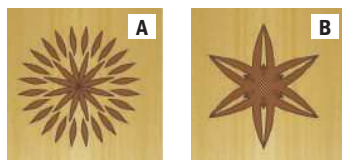

Rosette Carvings

You get two templates for the price of one with these designs! Each item includes templates for two sizes of rosette. Use with the rosette frame sold above, or use the large rosettes with the cabinet door frame or small rosettes with rail frame.

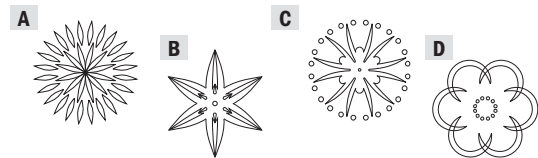

DESCRIPTION	CARVING DIMENSIONS mm	NO. OF TEMPLATES	ORDER NO.
Rosette #1 & #5 - A	85 & 68	2 & 2	RCS-701
Rosette #2 & #6 - B	88 & 70	1 & 1	RCS-702
Rosette #3 & #7 - C	82 & 65	1 & 1	RCS-703
Rosette #4 & #8 - D	79 & 62	1 & 1	RCS-704
Rosette Holding Frame			RCS-007

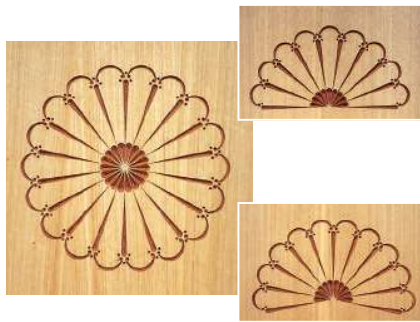

Southwestern Carving Designs

These popular Southwestern designs are actually several shapes in one. Both sizes can be routed as circular carvings, or use only portions of the template to suit your project.

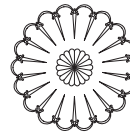

Rout the complete spanish fan design or make partial rosettes

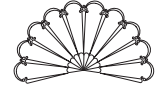
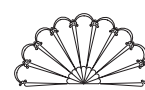

DESCRIPTION	CARVING DIMENSIONS mm	No. OF TEMPLATES	ORDER NO.
Large Spanish Fan	400	1	RCS-801
Small Spanish Fan	200	1	RCS-802
Rosette Holding Frame			RCS-007

**Just for fun:
Designs For
every animal
lover!**



Your imagination will be your guide on these neat designs. Furniture or decorations for the kids, paneling for the den or rec room, a gift for the sportsman.

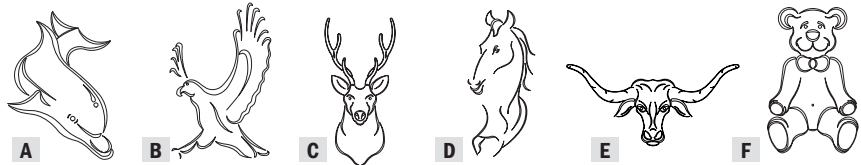

DESCRIPTION	CARVING DIMENSIONS mm	No. OF TEMPLATES	ORDER NO.
Dolphin - A	200 x 290	4	RCS-803
Eagle - B	178 x 298	4	RCS-804
Deer - C	394 x 190	4	RCS-901
Horse - D	445 x 203	3	RCS-902
Longhorn - E	419 x 194	4	RCS-904
Teddy bear - F	394 x 203	3	RCS-906
Cabinet Door Holding Frame			RCS-003

Organizer

100 bits at your fingertips

When you constantly work on projects, you always need your most used bits right within reach and safely organized. CMT gives you the perfect solution for keeping them all in sight, thanks to the 100 piece organizer.

This conveniently holds any size router or drill bit by using CMT's interchangeable bushings to fit all CMT shank diameters. See options listed below.

03.51



DESCRIPTION	ORDER NO.
Bit Organizer (without bushings)	03.51.0106
Interchangeable Bushings for Ø6mm shank (20-Pcs.)	03.51.0046A
Interchangeable Bushings for Ø6,35mm shank (20-Pcs.)	03.51.0047A
Interchangeable Bushings for Ø8mm shank (20-Pcs.)	03.51.0048A
Interchangeable Bushings for Ø9,5mm shank (20-Pcs.)	03.51.0057A
Interchangeable Bushings for Ø10mm shank (20-Pcs.)	03.51.0058A
Interchangeable Bushings for Ø12mm shank (20-Pcs.)	03.51.0059A
Interchangeable Bushings for Ø12,7mm shank (20-Pcs.)	03.51.0049A

Formula 2050: Blade & Bit Cleaner



Finally a safe, environmentally-friendly cleaner that is more effective than all those hazardous chemicals used for cleaning cutting tools. **998**

Saw shops know how to get the most out of cutting tools. They know that the pitch and resin left by wood on tools greatly shortens the life of carbide. Therefore we asked many blade sharpeners to test Formula 2050 and they rated it as an excellent product. Most blade and bit cleaning products work with dissolving action, but it takes some power and nasty chemicals to dissolve wood residues and adhesives. CMT's non-toxic and safe Formula 2050 penetrates the microscopic cracks in the resin and attacks the bond between carbide or steel surfaces and the resin itself. Formula 2050 keeps your tools clean and helps you increase the life span between sharpening and replacement.



Prolonged use of this product may cause damage to special coating treatments applied to aluminum tool surfaces. Use with caution.

DESCRIPTION		ORDER NO.
0,5 lt. spray bottle	8	998.001.01
5 lt. plastic jug	5	998.001.03

★★★★★

This product received a five-star performance rating from "Wood® Magazine"

Shipping terms and minimum orders must be arranged with the sales department.

- Removes pitch, resin and adhesive residue from all woodworking cutting tools (saw blades, router bits, drill bits, shaper cutters, planer blades, etc.).
- Completely non-toxic, non-flammable and certified biodegradable. Formula 2050 is a safe, earth-friendly product.
- Do not rinse after cleaning. Formula 2050 provides protection from rust and corrosion. Keeps your table saw top rust free too!
- Can be applied by spray bottle or used in ultrasonic cleaners and dip tanks.

Lubricant for Wood, Neutralizes Resin

- Neutralizes resin, preventing it from being stuck on chips and sawdust.
- Cleans knobs, barbell handles, etc.
- Anti-corrosion action on woodworking machine table.
- Excellent against humidity.

DESCRIPTION		ORDER NO.
1 lt. spray bottle	12	998.002.01
5 lt. plastic jug	2	998.002.03

Shipping terms and minimum orders must be arranged with the sales department.



998.002.01



INSTRUCTION: spray or apply the product on the desired parts of your woodworking machine. You will obtain a uniform layer on its surface that will aid in the sliding of your workpiece.



Watch the video on **YouTube**

998

TOOLBOX

Dobro jutro & Instrumenti **998.002.03**

www.TOOLBOX.lv info@toolbox.lv

Flexible Templates for Curved & Arched Routing

The CMT flexible template is easy to screw on any kind of wooden panels, MDF or chipboard for creating forms, arcs and curved elements easily and rapidly. In order to fix your template you can use countersunk screws, which are widely available on the market. The CMT template is made of a highly-resistant flexible plastic, which can be tied in knots without any risk of ruining or reducing flexibility.

Screw your template to the edge of the panel and follow its shape and rout the border on the guide ring. The template is suitable for manual feed on routers, router tables and spindle moulders. Rout safely and accurately to make multiple forms such as arcs, curved elements and cut-out forms. Mark the edge of your form precisely and screw it onto a previously-placed panel from underneath.

If you rout with a guide ring mounted onto your spindle moulder, keep your hands a safe distance behind the template. Two different profiles in three lengths are available. Please notice that the smallest profile features a short radius, whereas the larger profile features a larger opening in case of flat and long curves.

TECHNICAL SPECIFICATIONS:

- Special plastic without any plasticizer.
- Made in Germany.
- Lasts more than 10 years!

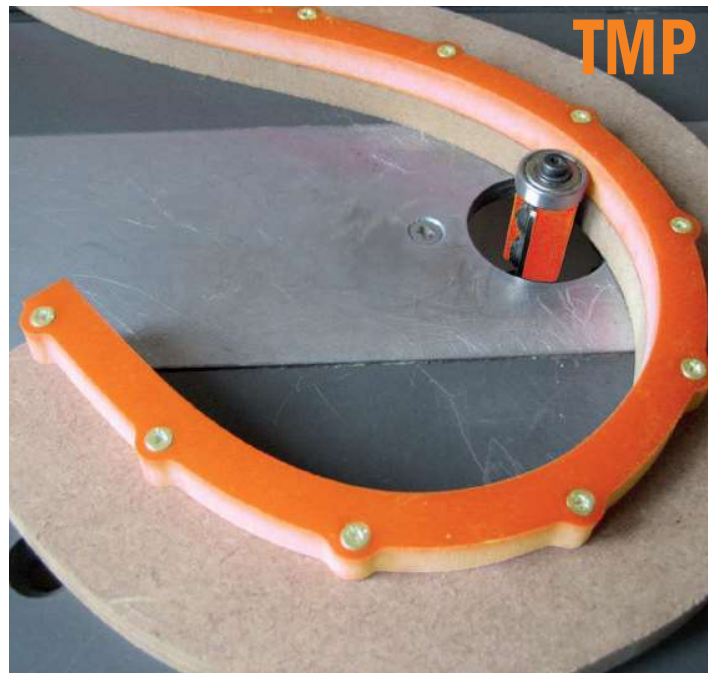

DESCRIPTION	L mm	ORDER NO.
Flexible template for routing 18x18mm	1000	TMP-1000
Flexible template for routing 12x12mm	1200	TMP-1200
Flexible template for routing 18x18mm	2000	TMP-2000

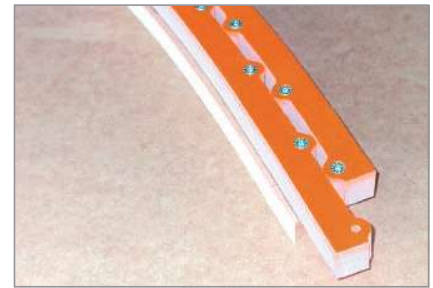
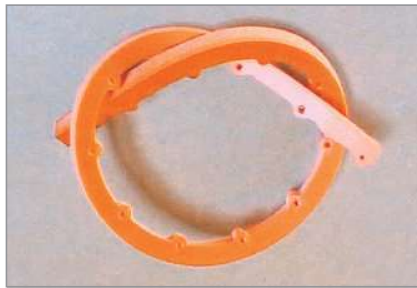

12 Corner Radius Router Template Set from 3mm to 25mm

Our useful 3-piece corner radius template set includes 8mm thick acrylic templates that will allow you to make 12 different radii (4 per template) by using a flush trim or a pattern bit (sold separately). Included with the templates you will also find 4 alignment pins and 4 wood screws. Use the pins to align the template onto your workpiece, then use the four wood screws provided to secure it. Remove the alignment pins and use the bit to cut the corner of your workpiece to the same radius as the template.

RADIUS	
mm	inches
3	1/8"
5	3/16"
6	1/4"
8	5/16"
10	3/8"
11	7/16"
12	1/2"
14	9/16"
16	5/8"
19	3/4"
22	7/8"
25	1"



DESCRIPTION	ORDER NO.
12 Corner Radius Router Template	TMP-R12
Set contains:	
12 Different Radii (3 templates)	
4 Alignment Pins	
4 Wood Screw	

Laminate/Veneered-Panel Cutter

A very useful hand tool for clean, splinter-free cuts on laminates and veneered with no waste. Place your material into the fence provided and have the cutter run along the edge of the panel. The two opposing steel-made circular cutting blades mounted on roller bearings will trace the cutting line. Use the micrometer knob on the top of the tool to set the cutting thickness, or adjust the strip width by using the metric/inch scale provided. Loosen the lock knob on the scale, move the metal bracket which holds the fence and tighten the lock knob again on the desired cutting width.

TECHNICAL FEATURES:

- Cutting width: 12~110mm (15/32" ~ 4-21/64").
- Cutting depth: 0~2mm (0 ~ 5/64").
- Weight: 1.2 kg (2.65 lbs).



DET-003

TOOLBOX

Darbagaldi & Instrumenti

www.TOOLBOX.lv

info@toolbox.lv

DESCRIPTION	ORDER NO.
Laminate/Veneered-Panel Cutter	DET-003

Edge Banding Iron

Apply pre-glued edge banding easily and accurately. The iron non-stick surface allows smooth and easy application. The thermostatically controlled short preheat time gets you working quicker. Includes heat resistant metal base to place iron when not in use.

- Includes thermostatic heat control.
- Non-stick coating.
- Specially shaped shoe with rounded edges.
- Metal stand.
- 154cm (5-1/2') power cord, 230V.



DET-004

TECHNICAL FEATURES:

- Voltage: 230V.
- Electric current: 2.5A.
- Low temperature: 70° ±10° C.
- High temperature: 150° ±10° C.

DESCRIPTION	ORDER NO.
Edge Banding Iron	DET-004

Edge Banding End Trimmer

An indispensable tool for easy and safe end trimming after edge banding. Position the tool on the banding, press down on the handle to operate the blade in a shearing action. The cutting knives are interchangeable, so when the cutting knife becomes dull, you can simply replace it with the anvil knife for a double lifetime. For cutting banding up to 0,5mm thick with a maximum cutting width of 54mm.

This tool can also be paired up with our double edge trimmer DET-001. We recommend using our edge banding end trimmer DET-002 before using our double-edge trimmer DET-001.

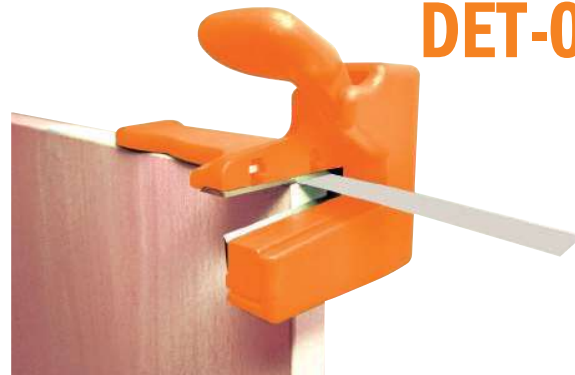

DET-002

DESCRIPTION	ORDER NO.
Edge Banding End Trimmer	DET-002

Spare parts **DET-002K** 2-Pcs replacement blade set 55x13x1,5mm

Double-Edge Trimmer

Attach this trimmer to your workpiece, press both ends against the board for a cutting range between 13mm (1/2") and 25mm (1"), move the trimmer in the correct direction indicated by the arrow. This will cut on both sides easily. The first cutter will cut straight, the second one can be adjusted for a tapering cut. Both cutters are made from high-quality hardened steel and can be easily replaced when worn out.



DET-001

DESCRIPTION	ORDER NO.
Double-Edge Trimmer	DET-001

Spare parts **DET-001K** Spare knives for double-edge trimmer

Digital Height Gauge



- Precise measurements for router bits, saw blades, band saw blades, cutter heads, drill bits, holes depth.
- Measuring ruler with Metric/Imperial scale and locking screw.
- Horizontal & vertical measuring.
- Digital easy-to-read display.
- Self-standing with magnets, for setting cutting depth on router tables and low profiles for backfence adjustment.
- Instruction manual.



TECHNICAL DETAILS:

- Measuring range: Scale: 0~80mm (0~3"); Needle: 0~50mm (0~2")
- Wide opening: 60mm (2.5")
- Resolution: 0.05mm (0.002")
- Accuracy: ±0.1mm (±0.004")
- Battery: **Included**
- Battery Type: CR2032-3V; Lithium Button Cell

DESCRIPTION	ORDER NO.
Digital Height Gauge	DHG-001

DHG-001



Place your gauge on a flat surface and set to "0" on the display.

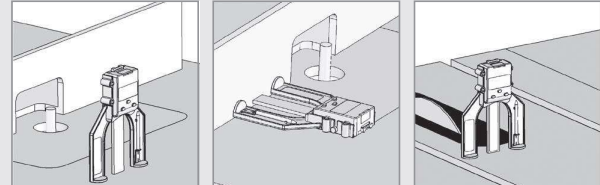

Position your gauge on the desired position.

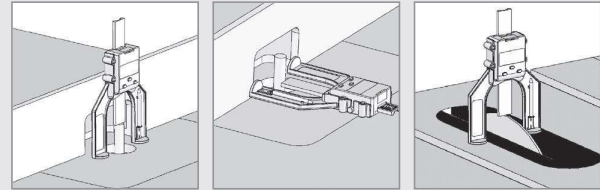

Insert needle and set to "0".

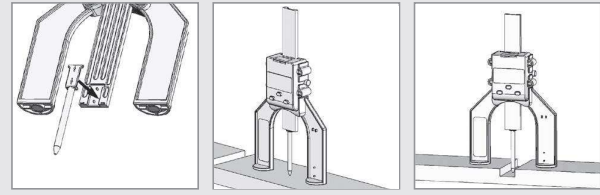

Digital Moisture Meter



Ideal for use in woodworking, building construction and agriculture industries. The DMM-001 is also an invaluable tool in the restoration field. Ideal for locating moisture in carpets and sub-flooring. Ultra-sensitive Digital Moisture Meter easily detects hidden leaks in wood, concrete, plaster and carpet. Providing accurate moisture level readings make this tool great for new home inspections, locating roof leaks or even selecting dry lumber at the yard. Display will show the moisture content in Percent Moisture Content directly.

DMM-001



Calibration holes

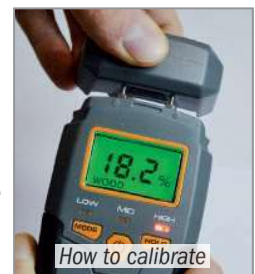

How to calibrate



TECHNICAL DETAILS:

- Moisture measuring range: 5~50% (in wood); 1.5~33% (in building material)
- Measuring accuracy: ±2%
- Backlight shut off: In about 15 seconds
- Auto power off: After 3 minutes idle
- Battery: **Included**
- Battery Type: 9V Battery Block (6F22 or 6LR6); Alkaline <7V
- Low battery indicator: <25mA
- Working current: <25mA
- Working temperature: 32°F~122°F
- Working humidity: <90%RH non-condensing
- Storage: -4°F~140°F ≤85% (without battery)
- Dimensions: 145 x 65 x 25mm (5-11/16" x 2-9/16" x 1")
- Weight: About 3oz (without battery)

- Measures moisture content by detecting a material's electrical resistivity using two pins.
- Measurement output is displayed on a practical LCD screen.
- Instruction manual.

DESCRIPTION	ORDER NO.
Digital Moisture Meter	DMM-001

Spare parts **DMM-001/1** Set 2 Pin for DMM-001

Digital Angle Gauge

DAG-001



The digital angle gauge is a mini waterproof digital protractor that provides digital readings between $\pm 90^\circ \times 4$ with a resolution of $0,1^\circ$ and features auto shut off after 5 minutes. It is small enough to be carried around in your pocket and the LED screen is easy to read. It incorporates magnets in the base for adhesion to any ferrous surface to accurately measure mitre and bevel angles on mitre saws, saw benches, etc.

- Accurately sets saw blade bevel angle, works great for miter saws and table saws.
- Automatic LCD backlight
- Large display for easy digital reading
- Measurements in absolute or relative mode
- Angles displayed in degrees
- Automatic digit inversion for overhead measurements
- Set to ZERO
- Magnetic base
- Case included
- Instruction manual

TECHNICAL DETAILS:

- Range: $\pm 90^\circ \times 4$
- Resolution: 0.1°
- Battery: **Included**
- Battery Type: AAA-1.5V; Alkaline
- Dimensions: 60 x 60 x 28mm (2-3/8" x 2-3/8" x 1-1/8")

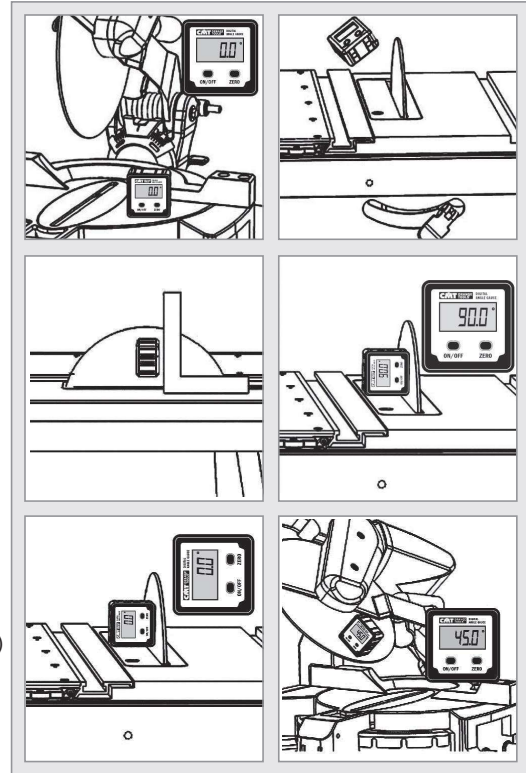

Watch the video on **YouTube**

DESCRIPTION	ORDER NO.
Digital Angle Gauge	DAG-001

Digital Angle Finder

DAF-001



This digital angle finder is a multi-functional tool for many measuring applications. Easy to operate, the base unit carries the electronics featuring clear detailed LCD display, a pair of levelling vials and a pivoting measuring arm. When the arm is extended, the angle created with the base is indicated clearly on digital read-out to the nearest 0.05° . The measuring range is $0 - 360^\circ$. The vials allow both vertical and horizontal variations to be accurately measured. Other features include a lock function to prevent the last measurement being lost, a low battery indicator and automatic shut off function. Robust yet lightweight, this tool is very versatile.

DESCRIPTION	ORDER NO.
Digital Angle Finder	DAF-001



Watch the video on **YouTube**



- Easy and simple to use.
- Calculates angles in seconds.
- Large detailed LCD display.
- Robust, lightweight aluminium construction.
- Instruction manual.

TECHNICAL DETAILS:

- Range: $0-360^\circ$
- Resolution: 0.05°
- Battery: **Included**
- Battery Type: CR2032-3V; Lithium Button Cell
- Dimensions: 260 x 50 x 25mm (10-1/4" x 2" x 1")

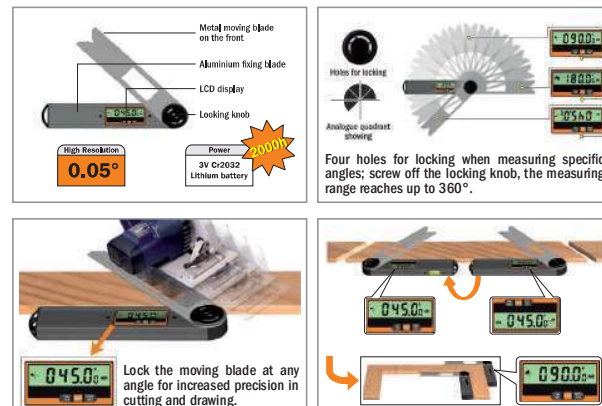

Diamond Whetstones

For professional, industrial and home users

FAST: real quality diamond, the hardest known material, reduces the sharpening process.

EASY: stoke the blade across the surface with little pressure.

DURABLE: we use natural diamonds for long-lasting performance.

VERSATILE: for sharpening any hard material, steel, glass, ceramic, tungsten carbide, etc.



DSS

FOR SHARPENING, HONING AND LAPPING

- axes
- bayonets
- broadheads
- cable cutters
- carbide cutters
- chainsaws
- chisels
- climbing equipment
- engraving tools
- farm and garden tools
- fish hooks
- Forstner bits
- knives
- lapidary tools
- lawn mower blades
- masonry drills
- moulds and dies
- plane blades
- planer /jointer knives
- pruners

FOR ABRADING HARD MATERIALS

- ceramic
- composites
- fibreglass
- glass
- stainless steel
- stone
- titanium
- tool steel
- tungsten carbide

FOR FLATTENING

- chisel backs
- engine heads
- machine bolsters and ways

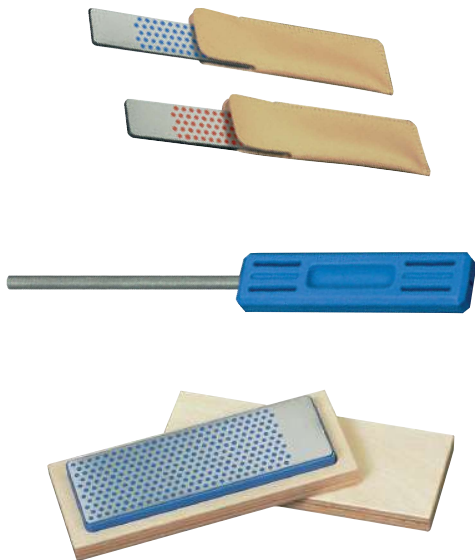

Universal diamond whetstone in leather sheaths

DIMENSIONS mm	GRAIN	COLOUR	ORDER NO.
115 x 25 x 3	D15 extrafine	green	DSS-115E
115 x 25 x 3	D25 fine	red	DSS-115F
115 x 25 x 3	D46 coarse	blue	DSS-115M
115 x 25 x 3	D76 extracoarse	black	DSS-115G

Diamond whetstone file

DIMENSIONS mm	GRAIN	COLOUR	ORDER NO.
100 Ø4,8	D54 coarse	blue	DSS-048M

Universal diamond whetstones in hardwood case

DIMENSIONS mm	GRAIN	COLOUR	ORDER NO.
150 x 52 x 16	D15 extrafine	green	DSS-150E
150 x 52 x 16	D25 fine	red	DSS-150F
150 x 52 x 16	D46 coarse	blue	DSS-150M
150 x 52 x 16	D76 extracoarse	black	DSS-150G

A unique production process to guarantee long tool life

A perforated steel plate is moulded onto a strong plastic base by applying high pressure. The steel is then covered with natural diamonds embedded into a nickel plate. The pattern and diamond coating ensures fast sharpening, whereas the plastic indents hold the lubricating water and disperse the fine dust emitted by the diamonds during sharpening.

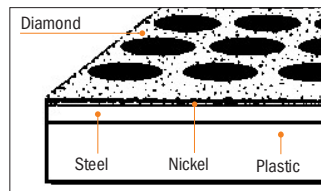

The diamond whetstones are available in four meshes for multiple purposes:

D15 EXTRAFINE/GREEN (9 microns, 1200 mesh)

To refine and polish sharp edges to razor sharp perfection. If you are new to sharpening or need your knife or tool edges as sharp as possible, this grain type but if this suffice, then this is what you are looking for.

D25 FINE/RED (25 microns, 600 mesh)

To restore any slightly dull knife or tool edges to perfect sharpness. Many customers consider the fine grit grain to be suitable to satisfy any working need. Professional chefs and gourmet cooks prefer using this grit grain too. This product is perfect for the edge refinement process before micro-refinement and polishing.

D46 COARSE/BLUE (45 microns, 325 mesh)

To quickly restore dull edges. For workers who require faster cutting action and less edge refinement often use this grit grain.

D76 EXTRA-COARSE/BLACK (60 microns, 220 mesh)

Recommended for aggressive removal of metal on damaged tools or for heavy-duty outdoor tools such as axes and lawn mower blades. Also, this grit grain is commonly used as a first step for flattening the back of chisel and plane irons or for rapid stock removal from chipped or badly damaged edges.

Instructions

Use water for lubrication, after use, rinse and store dry.

1. Keep your knife with cutting edge away from you.

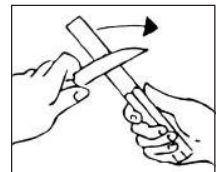

2. Apply some water to the stone surface. Hold blade 20° to diamond surface.

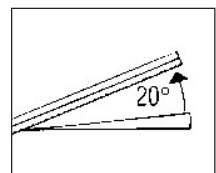

3. With little pressure and in long strokes push the blade across surface. From edge heel to edge tip, alternately on both sides. For pointed tools. Use the unperforated diamond area.

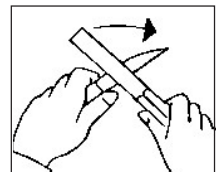

Bowl & Tray System

CMT System BTS-002 provides a fun and easy way for you to make divided bowls and trays in your shop. No lathe? No problem. This bowl making technique uses a router and CMT's unique bowl and tray router bit. The resulting bowls and trays are beautiful. This kit also provides an excellent way to use up scrap wood. Glue pieces together, butcher block style, to make a beautiful pattern of colors and species.

BTS-002

The templates will withstand a lifetime of use and can be used to make a variety of bowl or tray styles. The collet extension, used to make extra deep bowls, is also useful whenever your general woodworking requires extra deep cuts.



TMP-012
MDF Template



TMP-011
MDF Template



DESCRIPTION	ORDER NO. S=Ø12mm
Bowl & Tray System	BTS-002
<i>The kit includes</i>	
Router Bit	951.502.11B
Router Collet Extension	796.002.00
MDF Template nr. 1	TMP-011
MDF Template nr. 2	TMP-012
Instruction manual	



Join us on our
YouTube



Trace the templates onto the bowl blank.



Rough out the interior using a drill press and a 50,8mm Forstner bit.



Rout the interior to final shape using the bowl and tray router bit and collet extension.



Bandsaw the exterior to final shape.

Optional



TMP-101
MDF Template
400x400mm.



TMP-103
MDF Template
400x400mm.



TMP-105
MDF Template
330x300mm.

Folding Ruler

- Fiberglass material, water & scratch resistant.
- Impact resistant, tough yet flexible.
- No rust.
- Guaranteed professional quality.
- Merchanding display with 12 rulers.



FR2M

DESCRIPTION		ORDER NO.
Folding Ruler	12	FR2M

Carpenter Pencil

An easy-grip shape and larger rectangular surface area means this pencil won't roll away or slip from your hands. The non-round core makes highly legible thick or thin lines. Perfect for tracing high precision markings on virtually any surface and easy to erase.

Strong lead center withstands the stress of rough handling as well as the rigours and extreme conditions of the construction environment.



PCL-1

DESCRIPTION		ORDER NO.
Carpenter Pencil	50	PCL-1

CMT Professional Tool Bag

- Top zipped design and wide opening for accessing tools easily,
- Sturdy material and hard rubber bottom are resistant to rough handling and protects the contents from hard falls,
- 6 interior pockets, 12 exterior pockets,
- Ideal for storing and transporting hand tools as well as other medium sized items & accessories.

Material: Polyester 600D with 3mm EPE foam
Dimensions: 400x200x250mm



BAG-001

TOOLBOX

Darbagaldi & Instrumenti

www.TOOLBOX.lv

info@toolbox.lv

5 rubber studs at bottom



DESCRIPTION		ORDER NO.
CMT Professional Tool Bag	12	BAG-001

DISPLAY CABINETS

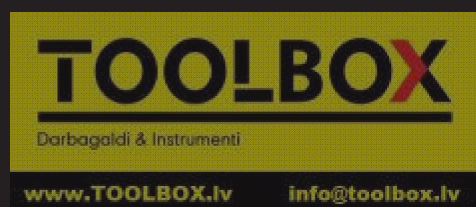

PRODUCTS	PAGE
Display Cabinets for Saw Blades	384
Display Cabinets for Sabre & Jig Saw Blades	385
Display Cabinets for Multi-Cutters	386
Display Cabinets for Router Bits	387
Display Cabinets for Router Bits & Forstner Bits	388
Display Cabinets for Hole Saws	389
Display Cabinets for Drill & Boring Bits	390
Multi Tools Mini Counter Display	391



Display Cabinets for Saw Blades



A sturdy steel saw blade display cabinet equipped with a backlight to place anywhere in your store. Hang and display a variety of different saw blades. Contact your CMT representative to seek advice on the most effective sawblade display composition for your needs. Tools not included.

03.00.0038

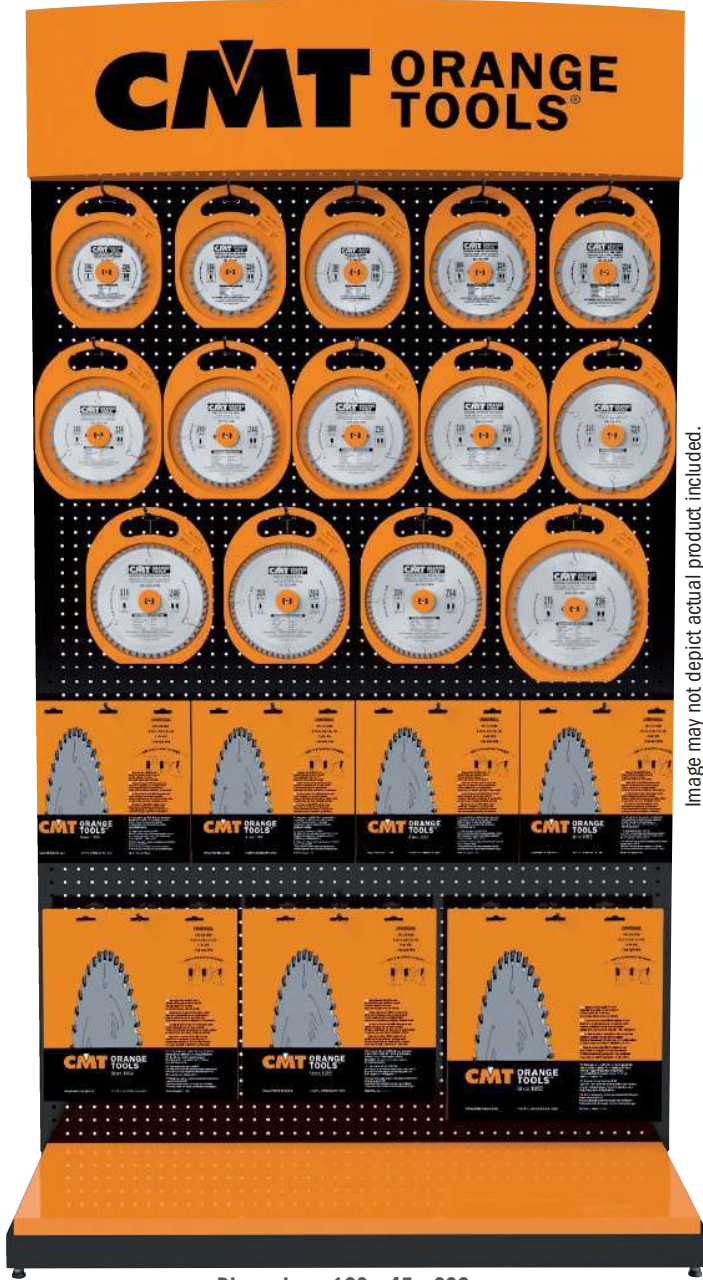

Dimensions: 120 x 45 x 223cm.

03.00.0030

We also offer a practical wire counter display for saw blades up to Ø350mm.



Dimensions: 51 x 49 x 27cm.

DISPLAYS THAT SELL!

Suitable for all blades types



03.53.0011-X24
(150mm.)



03.53.0012-X24
(50mm.)

DESCRIPTION	ORDER NO.
Wire counter display only (<i>empty</i>)	03.00.0030
Display cabinet with backlight (220V) for saw blades (<i>empty</i>) hooks not included, order separately	03.00.0038
Hooks 50mm. (24-pc pack)	03.53.0012-X24
Hooks 150mm. (24-pc pack)	03.53.0011-X24
Lighted header sign CMT ORANGE 220V (<i>spare parts</i>)	03.54.0084
220V LED wand for sign display cabinet (<i>spare parts</i>)	03.54.0097

Image may not depict actual product included.

Display Cabinets for Sabre & Jig Saw Blades



A sturdy steel sabre and jig saw blade display cabinet equipped with a backlight to place anywhere in your store. You can hang and display a variety of different blades. Contact your CMT representative to seek advice on the most suitable blade display composition for your needs. **Tools not included.**

IMBALLO143

Counter cardboard display for jig saw blades

CMT's end cap cardboard display for jig saw blades takes advantage of the existing space in your store and is designed for being placed on a counter, existing shelves or inside CMT's display cabinets.

Suitable for stocking up to 12 different jig saw blade types, 10 packs each, 120 packs in total. The end cap cardboard display helps increase product visibility and sell more!



DISPLAYS THAT SELL!

03.00.0038

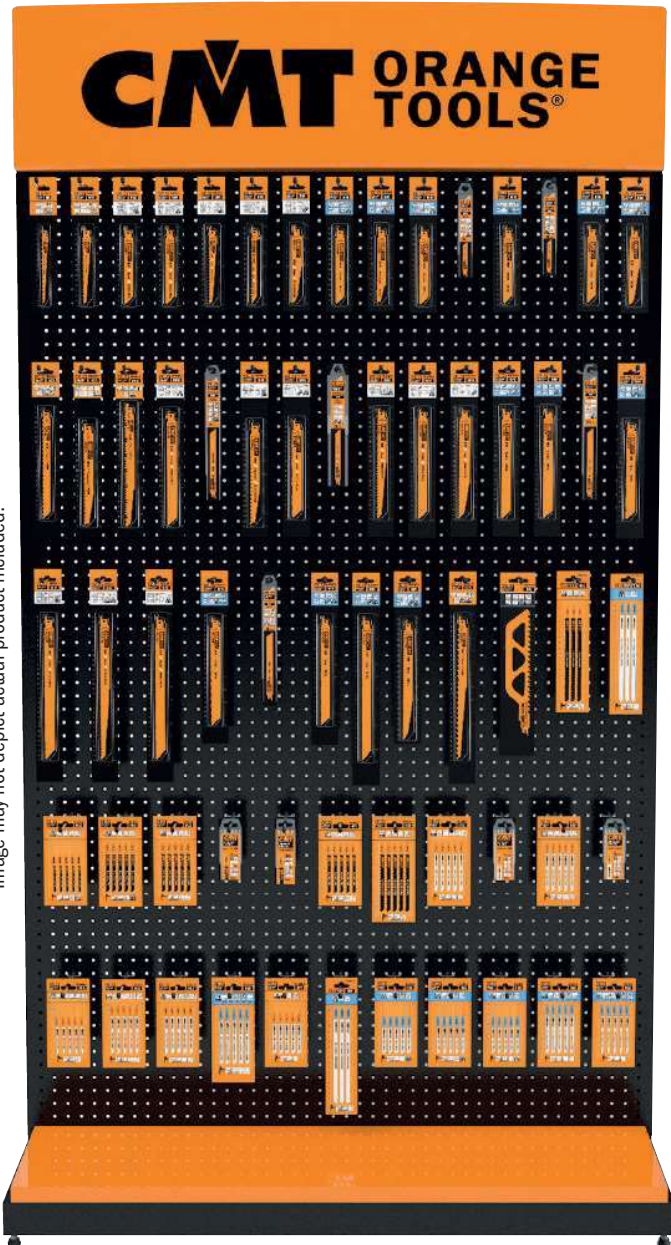

Image may not depict actual product included.



5-PIECE MASTERPACK



25-PIECE MASTERPACK



5-PIECE MASTERPACK



20-PIECE MASTERPACK

03.53.0020-X12
(50mm, for JS)



03.53.0012-X24
(50mm)



03.53.0011-X24
(150mm)

Dimensions: 120 x 45 x 223cm.

DESCRIPTION	ORDER NO.
Counter display only (empty)	IMBALLO143
Display cabinet with backlight (220V) for sabre and jig saw blades (empty) hooks not included, order separately	03.00.0038
Hooks 50mm. (24-pc pack)	03.53.0012-X24
Hooks 50mm. for JS (12-pc pack)	03.53.0020-X12
Hooks 150mm. (24-pc pack)	03.53.0011-X24
Lighted header sign CMT ORANGE 220V (spare parts)	03.54.0084
220V LED wand for sign display cabinet (spare parts)	03.54.0097

Display Cabinet for Multi-Cutters

A sturdy steel multi-cutter display cabinet featuring an attractive backlight to place anywhere in your store. You can hang and display a variety of different cutters. Contact your CMT representative to seek advice on the most most effective cutter display composition for your needs. **Tools not included.**

03.00.0038



**1-PIECE CLAMSHELL
5-PIECE MASTERPACK**



03.53.0011-X24
(150mm.)



03.53.0012-X24
(50mm.)

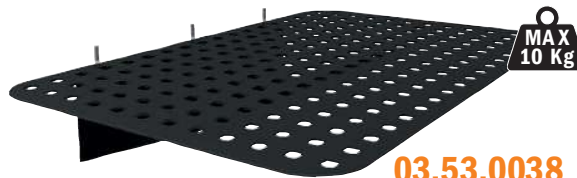

03.53.0038
Minimum order 2-pieces or multiple

Image may not depict actual product included.



Dimensions: 120 x 45 x 223cm.

**DISPLAYS
THAT SELL!**

DESCRIPTION	ORDER NO.
Display cabinet with backlight (220V) for multi-cutters (empty) hooks not included, order separately	03.00.0038
Hooks 50mm. (24-pc pack)	03.53.0012-X24
Hooks 150mm. (24-pc pack)	03.53.0011-X24
Lighted header sign CMT ORANGE 220V (spare parts)	03.54.0084
220V LED wand for sign display cabinet (spare parts)	03.54.0097

Display Cabinet for Router Bits



This sturdy structure is hand-crafted from MDF, tempered glass and iron. The cabinet is free-standing and provides 360° visibility thereby allowing you to position the display anywhere in your store. The front is a convenient 2 component assembly. The upper section is designed to display 141 of the best selling router bits from the CMT router bit line as well as 20 corresponding spare parts. The lower compartments can perfectly fit 10 of the most popular wooden box sets or saw blades, if required. Glass doors are secured with key lock.

03.00.0042



CMT Overall Rating 10!
Top Performing Router Bits



Deluxe packaging



03.53.0011-X24
(150mm.)



03.53.0017

Image may not depict actual product included.



Dimensions: 120 x 45 x 223cm.

DESCRIPTION	ORDER NO.
Display cabinets with: 240 HW router bits (S=Ø6mm), 66 spare parts (saw blades not included, at your choice)	700.300.00L
Display cabinets with: 240 HW router bits (S=Ø8mm), 66 spare parts (saw blades not included, at your choice)	900.300.00L
21 pcs. HW router bits with shank Ø12mm for our display cabinet (optional)	900.021.00
Display cabinet for router bits and cutter heads (empty) / Hooks not included, order separately	03.00.0042
Hooks 150mm. (24-pc pack)	03.53.0011-X24
Toolholder shelf (270x209x1,5mm.) for CMT display cabinet 03.00.0042 for router bit sets	03.53.0017
220V LED wand for sign display cabinet (spare parts)	03.54.0097
Set of 2 220V LED strips for display cabinet (spare parts)	03.54.0089
Set of 2 metal supports (RH-LH) for light header sign (spare parts)	03.53.0109
Lighted header sign CMT ORANGE 220V (spare parts)	03.54.0084

Display Cabinet for Router Bits & Forstner Bits

A beautiful, well-organized display of router bits in your shop is the best way to encourage customers to buy. CMT has produced this beautiful cabinet to best show off our wide selection of high quality bright orange bits, Forstner bits and boring bits. Made with a sturdy MDF frame and three glass panels, it is the ideal counter-top display. The wooden slat back wall allows for easy bit organization and comes standard with front door lock. Glass door secured with key lock.



CMT Overall Rating 10!
Top Performing Router Bits

03.00.0002



03.00.0002

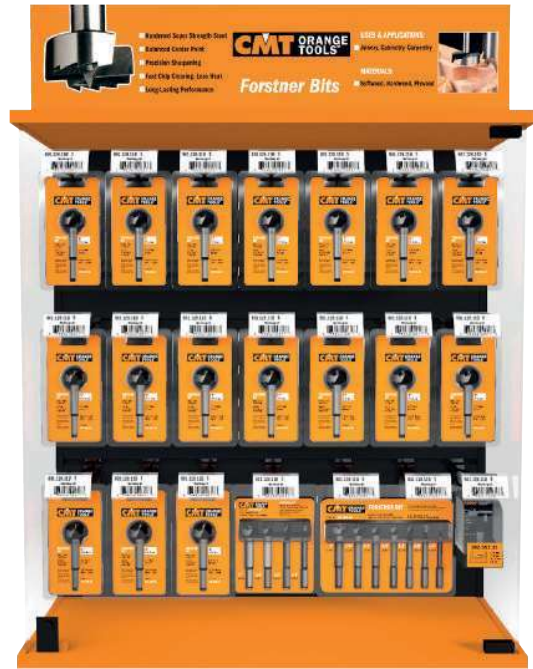

Image may not depict actual product included.

*Suitable for boring and Forstner Bits
(at your choice)*



Deluxe packaging



Forstner clamshell



03.53.0011-X24
(150mm.)

**DISPLAYS
THAT SELL!**

DESCRIPTION	ORDER NO.
Display cabinet with: 76 HW Router bits (S=Ø6mm), 8 Spare parts (2 pcs. each)	700.084.00
Display cabinet with: 76 HW Router bits (S=Ø8mm), 8 Spare parts (2 pcs. each)	900.084.00
Display cabinet for router bits / Forstner bits (empty) / Hooks not included, order separately	03.00.0002
Hooks 150mm. (24-pc pack)	03.53.0011-X24

Display Cabinet for Hole Saws



A sturdy steel hole saw display cabinet complete with a backlight to place anywhere in your store. You can hang a variety of different types of hole saws. Contact your CMT representative to seek advice on the best hole saw display composition for your needs. **Tools not included.**

NO LIMITS with the **FASTX4** hole saws you can bore any material of any hardness!

SERIES 550 TUNGSTEN CARBIDE-TIPPED SERIES 553 TUNGSTEN CARBIDE-TIPPED LONG



10X
LONGER LIFE
5X
FASTER

SERIES 551 BI-METAL PLUS 8% COBALT

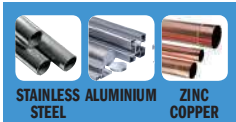

2X
LONGER LIFE

SERIES 552 DIAMOND DRY

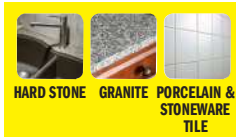

10X
LONGER LIFE

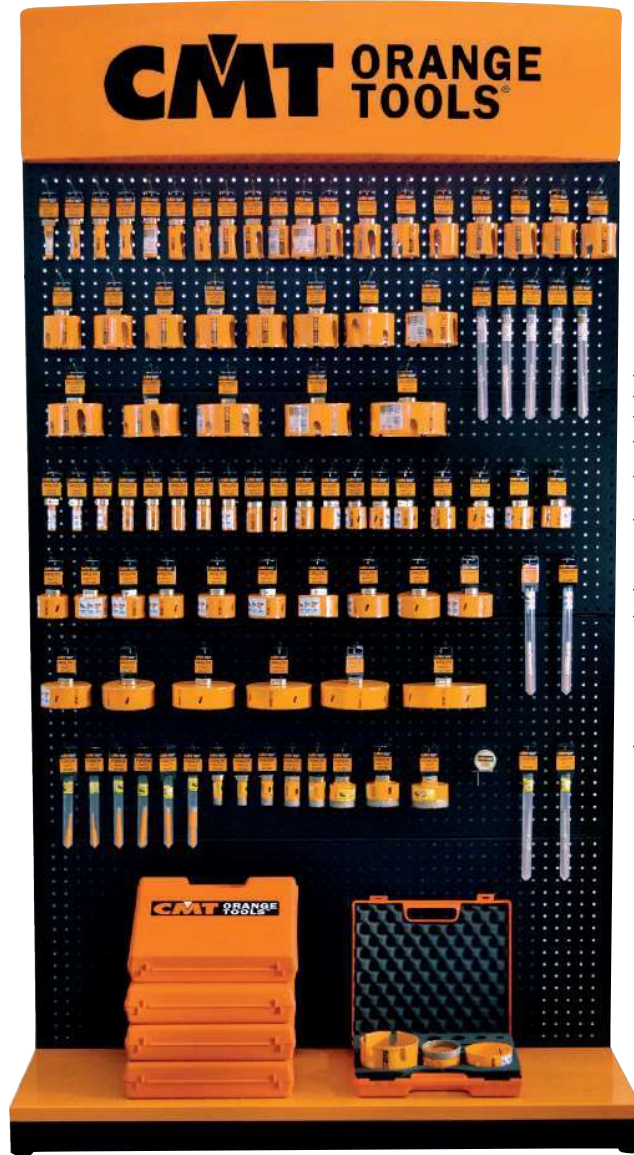

03.00.0038

CMT ORANGE TOOLS

Image may not depict actual product included.

Dimensions: 120 x 45 x 223cm.

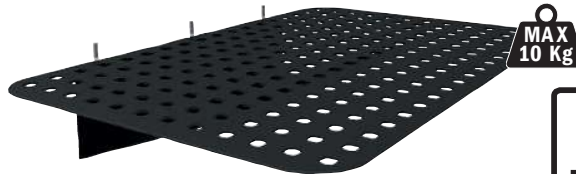

03.53.0038

Minimum order 2-pieces or multiple

DISPLAYS THAT SELL!

DESCRIPTION	ORDER NO.
Display cabinet with backlight (220V) for hole saws (empty) hooks not included, order separately	03.00.0038
Hooks 150mm. (24-pc pack)	03.53.0011-X24
Hooks 200mm. (24-pc pack)	03.53.0013-X24
Lighted header sign CMT ORANGE 220V (spare parts)	03.54.0084
220V LED wand for sign display cabinet (spare parts)	03.54.0097

Display Cabinet for Drill & Boring Bits



03.00.0042

Start your stock of CMT drill and boring bits now by ordering a convenient display to help you get organized and keep your tools within reach. Contact your CMT representative for information and get the best advice on choosing the right selection of drill bits for your display from our very broad range. Tools not included.

- Fit Top Selling 120 SKUs.
- Fit up to 20 Deep
- Secured Glass with Key Lock

X TREME BORING BITS



Image may not depict actual product included.



03.53.0017 Toolholder steel shelf for drill & boring bits. Fit up to 40 shelves into tower. Fastening screw for bit: 990.010.00
Dimensions: 270 x 209 x 1,5mm.



Dimensions:
120 x 31 x 223cm.

DISPLAYS THAT SELL!

DESCRIPTION	ORDER NO.
Display cabinet for drill and boring bits (empty) / Toolholder shelf not included, order separately	03.00.0042
Toolholder shelf (270x209x1,5mm.) for CMT display cabinet 03.00.0042 for drill and boring bits (order separately)	03.53.0017
220V lamp for neon sign for display cabinet (spare parts)	03.54.0087
Set of 2 220V LED strips for display cabinet (spare parts)	03.54.0089
Set of 2 metal support (RH-LH) for light header sign (spare parts)	03.53.0109
Lighted header sign CMT ORANGE 220V (spare parts)	03.54.0084

Multi Tools Mini Counter Display



03.00.0043

This simple yet attractive counter display will increase product visibility and definitely increase your sales. This cabinet supports a great variety of tools like jig saw blades, sabre saw blades, oscillating tools, router bits, Forstner bits, drill bits and hole saws. The best way to attract and encourage customers to buy! A sturdy steel body in our trademark orange colour makes for the ideal eye-catching counter-top display! Tools not included.

Suitable for all tools type

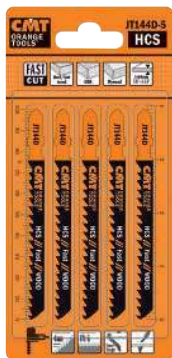

JIG SAW BLADES



SABRE SAW BLADES



OSCILLATING TOOLS



ROUTER BITS



FORSTNER BITS



HOLE SAWS

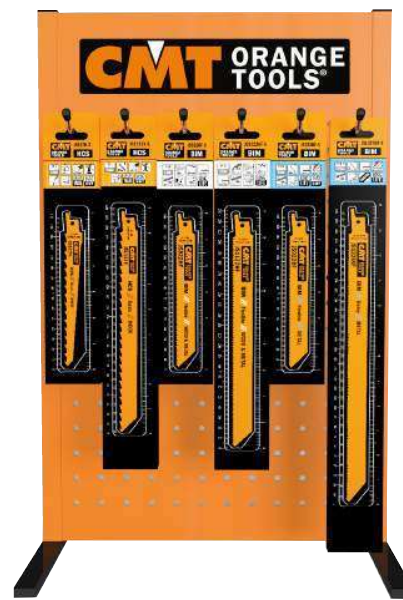
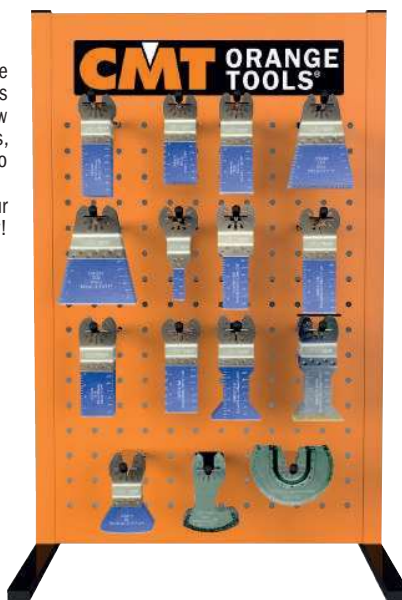

Dimensions: 35 x 56 x 16cm.

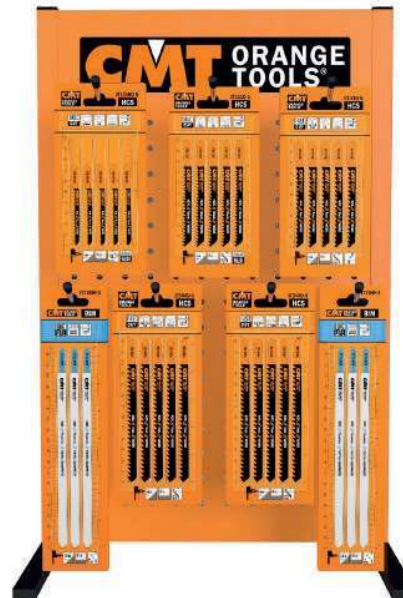
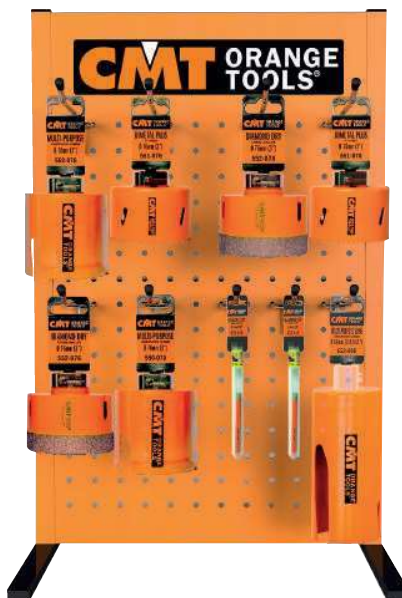
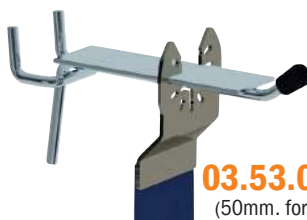

Image may not depict actual product included.



03.53.0012-X24
(50mm)



03.53.0014-X12
(50mm. for OMM & OMS)



03.53.0020-X12
(50mm. for JS)

DESCRIPTION	ORDER NO.
Mini Counter Display (empty) Hook not included, order separately	03.00.0043
Hooks 50mm. (24-pc pack)	03.53.0012-X24
Hooks 50mm. for OMM & OMS (12-pc pack)	03.53.0014-X12
Hooks 50mm. for JS (12-pc pack)	03.53.0020-X12

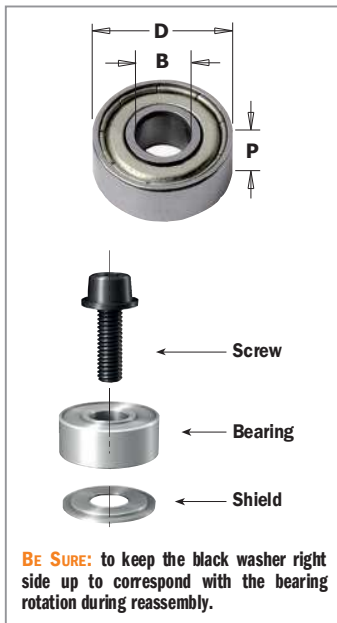

new

* Undersized diameter bearing for use after resharpening. Fits all tools such as flush trims

791.062.00 Ø9,3 replace bearing 791.002.00 (Ø9,5) after resharpening

791.063.00 Ø12,5 replace bearing 791.003.00 (Ø12,7) after resharpening

These bearings are supplied in a 10 pc. case. Minimum 10 piece or multiple of 10 piece order.



Bearings

	D		B		P		ORDER NO.
	mm	inches	mm	inches	mm		
	6,35	1/4	3,17	1/8	2,8	10	791.035.00
new	9,3		4,76	3/16	3,17	10	791.062.00*
	9,5	3/8	4,76	3/16	3,2	10	791.002.00
new	12,5		4,76	3/16	4,98	10	791.063.00*
	12,7	1/2	4,76	3/16	5	10	791.003.00
	12,7	1/2	6,35	1/4	4,8	10	791.010.00
	13		5		4	10	791.022.00
	13		6		5	10	791.023.00
	15		6		5	10	791.024.00
	15,8	5/8	4,76	3/16	5	10	791.018.00
	15,8	5/8	6,35	1/4	5	10	791.009.00
	16		5		5	10	791.006.00
	16		8		5	10	791.025.00
	19	3/4	4,76	3/16	7,5	10	791.019.00
	19		6		6	10	791.007.00
	19	3/4	6,35	1/4	7	10	791.004.00
	19		8		6	10	791.034.00
	19	3/4	12,7	1/2	4	10	791.011.00
	22		8		6	10	791.012.00
	22		8		7	10	791.005.00
	22,2	7/8	4,76	3/16	7,5	10	791.017.00
	22,2	7/8	9,52	3/8	7	10	791.021.00
	22,2	7/8	12,7	1/2	7	10	791.013.00
	24		8		8	10	791.036.00
	28		12		8	10	791.026.00
	28,5	1-1/8	4,76	3/16	8,4	10	791.014.00
	28,5	1-1/8	8		8,5	10	791.030.00
	28,5	1-1/8	12,7	1/2	8	10	791.027.00
	31,7	1-1/4	8		5	10	791.033.00
	31,7	1-1/4	12,7	1/2	8	10	791.015.00
	34,9	1-3/8	4,76	3/16	11,5	10	791.016.00
	34,9	1-3/8	8		11,6	10	791.031.00
	34,9	1-3/8	12,7	1/2	11	10	791.029.00
	37		12		12	10	791.028.00
	38,1	1-1/2	12,7	1/2	13,3	10	791.020.00
	62		30		16	10	791.051.00
	62		35		14	1	791.052.00
	80		40		18	1	791.054.00
	80		50		16	1	791.053.00

Delrin® Cylindrical Bearings

12,7	1/2	4,76	3/16	5	10	791.044.00****
15,87	5/8	4,76	3/16	7,2	10	791.045.00****
19,05	3/4	4,76	3/16	6,8	10	791.046.00****
37,4	12,7	1/2	15,7	10	791.047.00****	

10° Delrin® Conical Bearings

19	3/4	4,76	3/16	6,8	10	791.041.00**
22	7/8	4,76	3/16	6,8	10	791.048.00**

Delrin® Triangular Bearings

12,7	1/2	4,76	3/16	5,8	10	791.042.00***
19	3/4	4,76	3/16	7	10	791.043.00***



Shields for Bearings

DESCRIPTION		ORDER NO.	DESCRIPTION		ORDER NO.
Ø9,5mm	10	990.422.00	Ø12,7mm	10	990.423.00



Screws

990

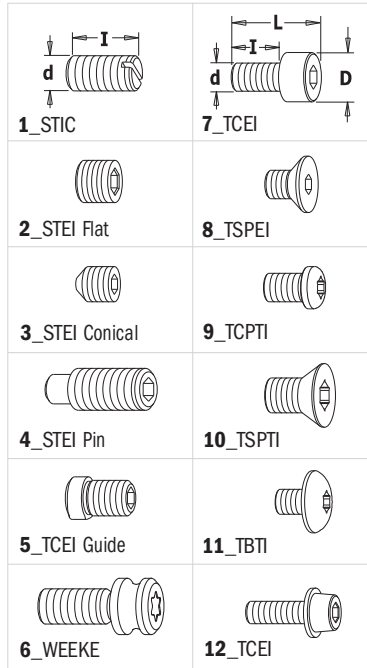

d x l x L mm	D mm	TYPE		ORDER NO.	d x l x L mm	D mm	TYPE		ORDER NO.
M5x8		1	10	990.008.00	M4x12x16	7	7	10	990.061.00
M5x10		1	10	990.003.00	M6x25x31	10	7	10	990.098.00
M2x2		2	10	990.060.00	M8x25x33	13	7	10	990.099.00
M4x4		2	10	990.016.00	1/8"x1/2"x5/8"	5,5	7	10	990.059.00
M4x20		2	10	990.091.00	M5x10x15	8,5	7	10	990.010.00
M5x4		2	10	990.015.00	M4x4x6	8	8	10	990.004.00
M5x5		2	10	990.001.00	M5x9x12	10	8	10	990.055.00
M5x5 w/cup point		2	10	990.006.00	M5x5,2x8	9	8	10	990.067.00
M3x3		3	10	990.005.00	M6x8x10	9	8	10	990.083.00
M5x5		3	10	990.002.00	M6x8,7x12	12	8	10	990.116.00
M6x6		3	10	990.007.00	1/4"x1/16"x7/8"	12	9	10	990.097.00
M4x3		3	10	990.013.00	1/8"x3/8"x1/2"	7	12	10	990.058.00
M4x4		3	10	990.014.00	M3x4x5,7 (T8)	4,6	9	10	990.082.00
M6x5		3	10	990.009.00	M4x5,5x8 (T20)	7,4	9	10	990.094.00
M6x8		4	10	990.087.00	M2,5x3x4,5 (T8)	3,5	10	10	990.070.00
M6x10		4	10	990.106.00	M2,5x4,5x6 (T8)	3,7	10	10	990.071.00
M6x16		4	10	990.066.00	M4x2x3 (T9)	6	10	10	990.079.00
M6x20		4	10	990.084.00	M5x3,6x6,1 (T25)	8,8	10	10	990.080.00
M6x25		4	10	990.085.00	M5x5x8 (T25)	9	10	10	990.093.00
M8x12		4	10	990.065.00	M5x13x18 (T15)	6,8	10	10	990.063.00
M8x16		4	10	990.064.00	M3,5x3,5x6 (T15)	6	11	10	990.072.00
M8x20		4	10	990.086.00	M3,5x4,8x6,8 (T15)	6	11	10	990.115.00
M5x5x9	6	5	10	990.068.00	M3,5x5x7,2 (T15)	8,8	11	10	990.073.00
M5x11,5x17		6	10	990.088.00	M3,5x5,7x8,2 (T15)	6	11	10	990.077.00
M2,5x6x8,5	4,5	7	10	990.062.00	M4x3,5x5,7 (T15)	8,8	11	10	990.074.00
M3x6x9	5,5	7	10	990.051.00	M4x4x6,2 (T15)	5,8	11	10	990.076.00
M3x10x13	5,5	7	10	990.053.00	M4x4x6,2 (T15)	8,8	11	10	990.056.00
M3x16x19	5,5	7	10	990.054.00	M4x6x8 (T15)	6	11	10	990.078.00
M4x6x10	7	7	10	990.052.00	M4x6x8,2 (T15)	9	11	10	990.075.00



Keys for Screws

991

DESCRIPTION		ORDER NO.	DESCRIPTION		ORDER NO.
Hex Keys			6mm	10	991.066.00
0,9mm (voor M2-bout)	10	991.055.00	Torx Key		
1,5mm (voor M3-bout)	10	991.056.00	T8	10	991.063.00
2mm	10	991.060.00	T9	10	991.069.00
3/32" (voor 1/8W-bout)	10	991.057.00	T15	10	991.061.00
2,5mm (voor M4-bout)	10	991.062.00	T20	10	991.072.00
3mm	10	991.067.00	T25	10	991.073.00
4mm	10	991.064.00	T30	10	991.071.00
5mm	10	991.065.00			

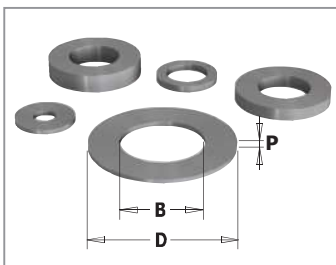

Shields for Assembly

541

B mm	D mm	P mm		ORDER NO.	B mm	D mm	P mm		ORDER NO.
3,25	9	1,6	10	541.550.00	8	14,7	5,8	10	541.519.00
3,25	15,8	2	10	541.552.00	12	20	2	10	541.512.00
5,2	15,8	2,5	10	541.551.00	12	20	3	10	541.511.00
6,4	9,52	2,2	10	541.514.00	12	21	0,1	10	541.513.00
8	14	0,1	10	541.515.00	12	21	0,3	10	541.520.00
8	14	0,3	10	541.516.00	12	21	1,59	10	541.521.00
8	14	0,5	10	541.517.00	12	21	3,18	10	541.522.00
8	14	1	10	541.518.00	12	21	6,16	10	541.523.00
8	14,7	3	10	541.500.00	12	21	1	10	541.524.00
8	14,7	4	10	541.501.00	12	21	0,5	10	541.525.00



Nuts for Arbors

990.0

DESCRIPTION		ORDER NO.	DESCRIPTION		ORDER NO.
M4	10	990.092.00	M8	10	990.020.00
M6	10	990.095.00	M12x1,25mm	10	990.022.00

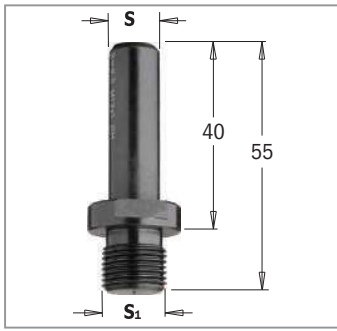

Arbors

797

S mm	S ₁ mm			ORDER NO.
8	M10x1,5		10	797.580.00
10	M12x1		10	797.100.00
12	M12x1		10	797.120.00
12,7	M12x1		10	797.127.00

TECHNICAL DETAILS:

- Super strength steel.
- Precisely machined for accuracy.

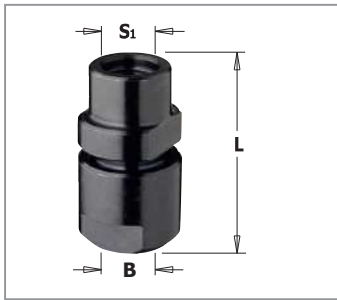

Collet Chucks

796

S ₁ mm	B mm	L mm		ORDER NO.
M10x1,5	6 - 6,35 - 8 - 9,5	38	10	796.100.00
M12x1	6 - 6,35 - 8 - 9,5	38	10	796.000.00
M12x1	10 - 12 - 12,7	47	10	796.121.00

TECHNICAL DETAILS:

- Super strength steel.
- Precisely machined for accuracy.

Collet not included.



Router Chuck Extensions with Collet

796.001/002

S mm	COLLET INCLUDED mm	FOR COLLETS mm	L mm		ORDER NO.
12	8	6 - 6,35 - 8 - 9,5	81	10	796.002.01
12	12	10 - 12 - 12,7	88	10	796.002.00
12,7	6,35	6 - 6,35 - 8 - 9,5	81	10	796.001.01
12,7	12,7	10 - 12 - 12,7	88	10	796.001.00

TECHNICAL DETAILS:

- Super strength steel.
- Precisely machined for accuracy.

Collet included.

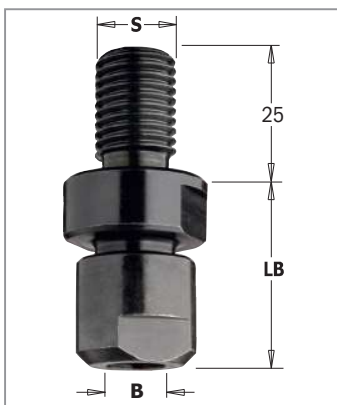

Collet Chucks

796

S mm	FOR COLLETS mm	LB mm		ORDER NO.
M14x2	6 - 6,35 - 8 - 9,5	32	10	796.140.00
M14x2	10 - 12 - 12,7	38	10	796.141.00
M16x2	6 - 6,35 - 8 - 9,5	32	10	796.160.00
M16x2	10 - 12 - 12,7	38	10	796.161.00

TECHNICAL DETAILS:

- Super strength steel.
- Precisely machined for accuracy.

Collet not included.



Collets

796.500/600

B mm		ORDER NO.	B mm		ORDER NO.
6	10	796.560.00	10	10	796.600.00
6,35	10	796.564.00	12	10	796.620.00
8	10	796.580.00	12,7	10	796.627.00
9,5	10	796.595.00			



Arbors

798

S mm	S ₁ mm		ORDER NO.
M10x1,5	M10x1,5	10	798.101.00
M10x1,5	M12x1	10	798.102.00
M12x1	M10x1,5	10	798.121.00
M12x1	M12x1	10	798.122.00

TECHNICAL DETAILS:

- Super strength steel.
- Precisely machined for accuracy.

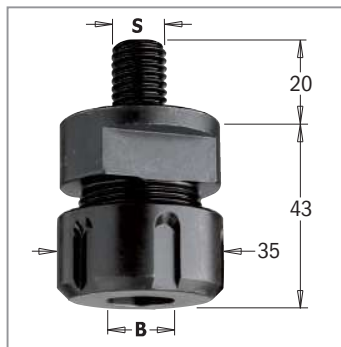

“ER20” Chucks

796

S mm	FOR COLLETS “ER20” mm	LB mm		ORDER NO.
M12x1,75	3 ~ 12,7	43	10	796.122.00
M14x2	3 ~ 12,7	43	10	796.142.00
M16x2	3 ~ 12,7	43	10	796.162.00

Spare parts: 992.483.03 M25x1,5mm clamping nut
991.483.00 “ER20” key

TECHNICAL DETAILS:

Super strength steel. Precisely machined for accuracy.

Collet not included.



“ER20” Precision Collets for 796.122/142/162 Items

184

B mm		ORDER NO.	B mm		ORDER NO.
3	10	184.030.20	8	10	184.080.20
5	10	184.050.20	10	10	184.100.20
6	10	184.060.20	12	10	184.120.20
6,35	10	184.064.20	12,7	10	184.127.20



Collets for CMT1E, CMT2E, DeWalt®, Felisatti®, Fein®, Metabo® Hand-Held Routers **796.8**

B mm		ORDER NO.	B mm		ORDER NO.
6	10	796.860.00	10	10	796.900.00
6,35	10	796.864.00	12	10	796.920.00
8	10	796.880.00	12,7	10	796.927.00
9,5	10	796.895.00			

Spare parts: 992.100.01 M22 clamping nut



Collets for Freud®/Casals® Hand-Held Routers

796.780

B mm	L mm		ORDER NO.
8	14	10	796.780.00

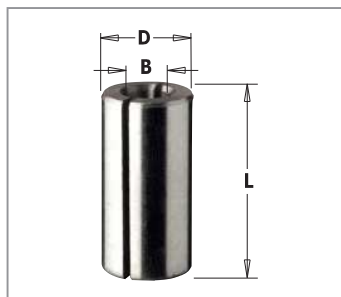

Bushings

799

B mm	D mm	L mm		ORDER NO.	B mm	D mm	L mm		ORDER NO.
6	8	25	10	799.060.00	8	10	25	10	799.280.00
6	9,5	25	10	799.160.00	8	12	25	10	799.380.00
6	12	25	10	799.260.00	8	12,7	25	10	799.480.00
6,35	8	25	10	799.064.00	9,5	12,7	25	10	799.001.00
6,35	9,5	25	10	799.164.00	10	12	25	10	799.100.00
6,35	12,7	25	10	799.264.00	13	16	45	10	799.130.00
8	9,5	25	10	799.180.00					



Stop Collars

541

B mm	Box	ORDER NO.	B mm	Box	ORDER NO.
3,175	10	541.008.00	9,5	10	541.006.00
6	10	541.003.00	12	10	541.005.00
6,35	10	541.001.00	12,7	10	541.002.00
8	10	541.004.00			

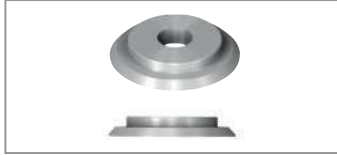

Threaded Rings for 694.001 Cutter Heads

695.996

DESCRIPTION	Box	ORDER NO.
M4 (Ø10x1,6mm)	10	695.996.01
M4 (Ø12x1,7mm)	10	695.996.02

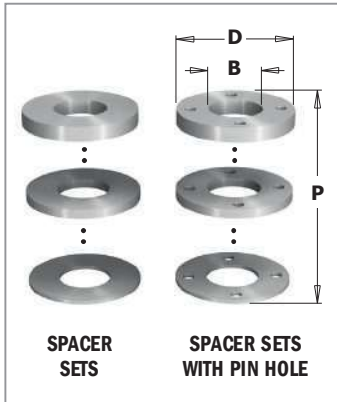

Spacers Set

695.998

DESCRIPTION D x B x P mm	FOR CUTTER HEAD	Box	ORDER NO.	DESCRIPTION D x B x P mm	FOR CUTTER HEAD	Box	ORDER NO.
Spacer Sets				Spacer sets with Pin Hole			
50x30x9	694.015	10	695.998.01	65x30x8	694.001 & 694.015	10	695.998.21
50x31,75x9	694.015	10	695.998.02	65x31,75x8	694.001 & 694.015	10	695.998.22
55x35x9	694.015	10	695.998.03	65x35x8	694.001 & 694.015	10	695.998.23
60x40x9	694.015	10	695.998.04	70x40x8	694.001 & 694.015	10	695.998.24N
70x50x9	694.015	10	695.998.05	70x50x8	694.001 & 694.015	10	695.998.25N
50x30x33	694.005	10	695.998.11				
50x31,75x33	694.005	10	695.998.12				
55x35x33	694.005	10	695.998.13				
60x40x33	694.005	10	695.998.14				
70x50x22	694.005	10	695.998.15				

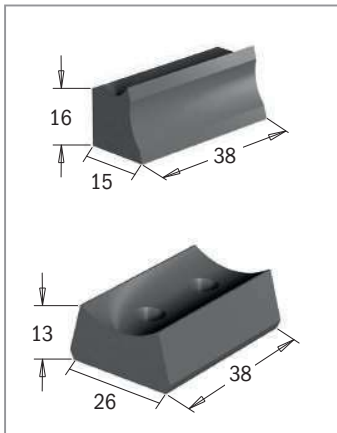

Wedges for Cutter Heads

651-692-693-695

DESCRIPTION	Box	ORDER NO.	DESCRIPTION	Box	ORDER NO.
Wedge for Cutter Heads			Wedges for Router Bits with Knives		
38x15x16mm	10	692.999.01	31x11x9,5mm	10	695.999.31
38x22,5x13mm	10	692.999.02	38x11x9,5mm	10	695.999.38
38x26x13mm	10	693.999.01	39x11x9,5mm	10	695.999.39
38x28x12,5mm	10	693.999.02	41x11x9,5mm	10	695.999.41
38x15x16mm (per/para 695.018)	10	695.018.01	42x11x9,5mm	10	695.999.42
7x11x9,5mm	10	695.999.07	46x11x9,5mm	10	695.999.46
16x11x9,5mm	10	695.999.16	49x11x9,5mm	10	695.999.49
17x11x9,5mm	10	695.999.17	53x11x9,5mm	10	695.999.53
22x11x9,5mm	10	695.999.22	D=8x20mm	10	651.999.01
23x11x9,5mm	10	695.999.23	D=10-12-12,7x30mm	10	651.999.02
23x11x9,5mm	10	695.999.24	D=12-12,7x50mm	10	651.999.03

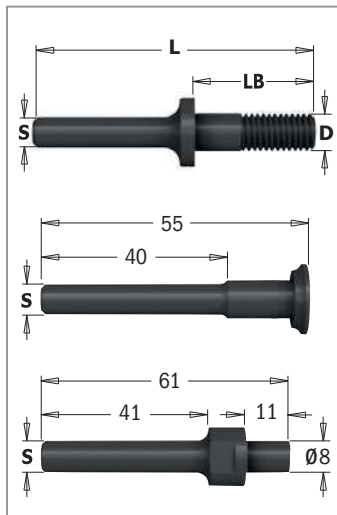

Slot Cutter Arbors

7/8/924

D mm	LB mm	L mm	Box	ORDER NO. S=Ø6mm	ORDER NO. S=Ø6,35mm	ORDER NO. S=Ø8mm	ORDER NO. S=Ø12mm	ORDER NO. S=Ø12,7mm
Arbors for 822 Slot Cutters								
M8	26	61	10	724.060.00	824.064.00	924.080.00		
M8	40	86	10			924.083.00		
M8	26	67,5	10				924.120.00	824.127.00
M8	40	81	10				924.128.00	824.128.00
M12	54	97	10				924.129.00	824.129.00
M8	47	97	10				924.130.00	824.130.00
M8	29,75	71	10				924.131.00	824.131.00
M8	35,5	71	10				924.132.00	824.132.00
M8	23	71	10				924.133.00	824.133.00
M12	39,5	85	10				924.134.00	824.134.00
M12	54,5	100	10					824.135.00
Arbors for 823 Slot Cutters with Counterbore								
		55	10	724.061.00	824.061.00	924.081.00		824.121.00
8	11	61	10	724.062.00	824.062.00	924.082.00		824.122.00

Alphabetical index

DESCRIPTION	PAGE
1 Piece Rail & Stile Cutter Heads	114
12 Corner Radius Router Template Set from 3mm to 25mm	376
12-Piece Router Bit Sets	228
13 Piece Multiprofile Cutter Head Sets without Limiters	116
13-Piece Router Bit Sets	228
15-Piece Router Bit Sets	227
15° Dovetail Cutter with Insert Knives for Roof-Frames	186
1KW Router	352
2 Flute Dowel Drills	302-303
2 Flute Dowel Drills for Through Holes	308-309
2 Piece Adjustable Grooving Sets	99
2 Piece Adjustable Rounding & Chamfering Sets.....	101
2-Piece Entry Door Router Bit Set.....	231
2.4KW Router	353
26-Piece Router Bit Sets	227
3 piece Adjustable Grooving Sets	98
3-Flute Slot Cutter for STRIPLOX™	219
3-Flute Solid Carbide Countersink 90°	310
3-in-1 Flush Trim Bits for MDF/Laminate	164
300W Oscillating Multi-Tools.....	355
3D Router Carver System	372-374
4 Flute Dowel Drills	304-306
4 Flute Dowel Drills for Through Holes.....	309
4-Wing Cut Out Slot Cutters for Solid Surfaces	223
45° Chamfer Cutter Heads	102
45° Countersink with Parallel Shank	334
45° Lock Miter Cutter Heads	109
5-Piece Boring Bit Set for Hinges.....	320-321
5-Piece Spiral Bit Sets.....	237
5-Piece Straight Bit Set & Profile Bit Set	236
5% Co HS Spiral Bits for Aluminium Positive Single Flute	153
5% Co HS Spiral Bits for High Cutting Depth	153
550W Professional Trimmer.....	354
6-Piece Mortising Bit Sets.....	284-285
6-Piece Profile Bit Sets.....	230
60° Lettering Bit	187
7 Piece Multiprofile Cutter Head Sets with Limiters	117
9° Dovetail Cutters.....	186
90° Countersink with Parallel Shank	334-335

DESCRIPTION	PAGE
A	
Adapters.....	292-294, 318-319
Adapters for Twist Drills	300
Additional Templates, Bits & Accessories	363
Adjustable Chamfer Cutter Heads with Positive Stop	103
Adjustable Chamfering CNC Cutter	280
Adjustable Countersink	332
Adjustable Double Roundover Router Bits.....	204
Adjustable Precision Router Dado Jig.....	361
Adjustable Roundover & Bevel Router Bits	204
Adjustable Scoring Blades Industrial Line	23
Adjustable Shaker Router Bit Sets	235
Adjustable Tongue & Groove Bit Set for Mission Style Cabinet Doors.....	235
Auger Bits	328
B	
Back-to-Back Connectors for Straight Edge Clamps (optional)	360
Ball End Bit	194
Bead & Bull Nose Bits	206
Beading Bits	197
Bench Block Set	368
Bi-Metal Plus Hole Saws.....	344-345
Biscuit Joiner Saw Blades	39
Blank Knives & Limiters (to be sharpened)	132
Blum Hinges Boring Head	368
Boring Bit & Plug Cutter Sets.....	325
Boring Bits with Parallel Shank	320-323
Boring head System 32	368
Bowl & Tray Bits	187
Bowl & Tray System	381
Brad Point Bit Sets	330
Brad Point Bits.....	328, 330-331
Bushings for Twist Drills.....	300
C	
C-Spanner for "DIN6388" & "ER40"	252
C-Spanner for "ER32" Precision Collets.....	251
C-spanner for "ER40" Precision Collets	249
Calibration & Sanding Disks	40
Cap Nuts for CNC Machines	254



Alphabetical index

DESCRIPTION	PAGE
Carbide Spiral Slot Mortising Bits with Chip-Breaker	287
Carpenter Pencil	382
Cavetto Edge Mould Bits.....	196
Chamfer Bit	242
Chamfer Bits.....	191-192
Chamfer Bits with Insert Knives	191
Chamfer Set.....	192
Chucks & "ER20" Collets for Spindle Moulder Machine	132
Chucks for "ER32" Precision Collets	251
Circular Saw Blade for Patch Work & Repair	40
Clamping Nuts	252
Clamping Nuts for Chucks with "ER32" Collets	251
Clamping Nuts for Chucks with "ER40" Precision Collets	249
Classical Bead Bits	200
Classical Ogee Bits	202, 244
CMT Contractor Tools® Saw Blade Combo.....	36
CMT Contractor Tools® Saw Blade Masterpack.....	36
CMT Inlay Kit	369
CMT Moulding System	207
CMT Professional Tool Bag	382
CMT's Complete Kitchen Set.....	233
Collets for 123 Chucks	254
Combination Trimmer Bits.....	160-161
Complete Set for Decorating on MDF.....	281
Complete Set for MDF Doors.....	282-283
Conical Scoring Blades Industrial Line	24
Corner Beading Bit with 45° Chamfer	205
Corner Beading Bits.....	206
Countersinks for 2 Flutes Dowel Drills.....	310
Countersinks for 4 Flutes Dowel Drills.....	310
Countersinks with Threaded Shank	332
Cove Bit Set.....	195
Cove Bits.....	195, 243
Crosscut Saw Blades for Portable Machines.....	34
Cutter Arbor with HSK Tapered Shank	256
Cutter Heads for Rabbering with 40mm Profile Knives.....	97
Cutter Heads with Limiters	115
Cutter Heads without Limiters	115
Cutting & Filing Tools for Multi-Cutters	79-80
Cutting & Scraping Tools for Multi-Cutters.....	81-82
Cutting Tools for Multi-Cutters.....	73-78

DESCRIPTION	PAGE
D	
Dado & Planer Bits	157
Dado Saw Blades.....	37
Decorative Beading Bits	200
Decorative Ogee Bit	199, 201, 241
Diamond Dry Hole Saws	346-348
Diamond Whetstones	380
Digital Angle Finder	379
Digital Angle Gauge.....	379
Digital Height Gauge.....	378
Digital Moisture Meter	378
Display Cabinet for Drill & Boring Bits	390
Display Cabinet for Hole Saws	389
Display Cabinet for Multi-Cutters	386
Display Cabinet for Router Bits.....	387
Display Cabinet for Router Bits & Forstner Bits	388
Display Cabinets for Sabre & Jig Saw Blades	385
Display Cabinets for Saw Blades	384
Divided Light Door Sets.....	229
Double-Bearing Spiral Flush Trim Bits.....	164
Double-Edge Trimmer	377
Dovetail Bit	184-185, 242
Dowel Drills	298
Dowel Drills for Mafell® & Hand-Held Routers.....	329
Dowel Drills for Through Holes.....	299
Dowel Drills for Through Holes with Countersink.....	307
Dowel Drills with Countersink	307
Dowel Drills with Threaded Shank.....	316
Dowel Drills with Threaded Shank with Countersink.....	314-315
Dowel Drills with Threaded Shank without Countersink	314-315
DP Conical Scoring Blades Xtreme Line.....	22
DP Corner Rounding Router Bits for Composites and Laminates	199
DP Flush Trim Bits for Laminates.....	163
DP Hinge Boring Bits with Chipbreaker	311
DP Laminated & Chipboard Saw Blades Xtreme Line	22
DP Router Cutters.....	270
DP Router Cutters with 20° Shear Angle.....	272
DP Router Cutters with 40° Shear Angle.....	274
DP Router Cutters with 45° Shear Angle.....	271
DP Router Cutters with Negative Shear Angle	270
DP Router Cutters with Shear Angle	271-272

Alphabetical index

DESCRIPTION	PAGE
DP Router Cutters with Shear Angle for Nesting (Densimet® Tungsten Heavy Metal Alloys).....	273
DP Saw Blades for Ultra-Hard Materials.....	33
DP Spiral Router Cutters with Shear Angle.....	273
Drawer Lock Bits	179
Drill Bit with Countersink for Screw Joints	335
Drill Bits for ANUBA Hinges.....	331
Drill Bits with 45° Countersink Set	333
Drill Bits with 90° Countersink Set	333
Dry Cutter Saw Blades for Metal Industrial Line	28

E	
Edge Banding Bits Set.....	183
Edge Banding End Trimmer	377
Edge Banding Iron	377
Edge-Fluting Bits	207
Ellipse & Circle Cutting Jig	364
Entry & Interior Door Router Bit Set	230

F	
FILE-FREE Flush Trim Bits for Laminate.....	165
Fine Cut-Off Saw Blades for Portable Machines.....	35
Fine Cut-Off Saw Blades for Two-Sided Melamine Industrial Line	15
Fine Cut-Off Saw Blades for Two-Sided Melamine Industrial Line	16-17
Finger Joint Bit.....	182
Finger Pull Bit	211, 245
Finger pull door lip bit.....	210
Finishing Saw Blades Industrial Line.....	13
Flexible Templates for Curved & Arched Routing	376
Flooring Router Bits.....	172
Flush Trim Bit Set	162
Flush Trim Bits	162, 240
Flush Trim Bits with Insert Knives.....	165
Flush Trim Router Bits with Double Bearing	166
Flute & Bead Set	176
Folding Ruler	382
Formula 2050: Blade & Bit Cleaner.....	375
Forstner Bit Sets.....	326
Forstner Bits.....	326

DESCRIPTION	PAGE
G	
Garden Trimmer Saw Blades	32
Glass Panel Sets.....	229
Grand Rabbeting Bits with Insert Knives	169
Grinding Wheels for XTreme Sharpening.....	296
Grooving Saw Blades.....	39
Grooving Saw Blades Industrial Line.....	38
Guide to Choosing the Most Suitable Jig Saw Blade.....	52

H	
Hinge Boring Bits	312-313
Hinge Boring Bits with Chipbreaker	312
Hinge Recesser Bits	157
Hole Saw Application Chart	339
Hole Saws Accessories.....	343
HS Corrugated Back Moulder Knives	133
HSK Chuck for Grooving Blade	255
HSK Chuck for "DING388" - EOC25 Precision Collet	252
HSK Chuck for "ER32" Precision Collets	250
HSK Chucks for "ER40" Precision Collets	249
HWM Reversible knives.....	136-137
HWM Reversible Knives for Portable Planers	138

I	
Industrial Chrome-Coated Adjustable Scoring Blades	23
Industrial Chrome-Coated Scoring Blades.....	24
Industrio Routing System	357
Interchangeable Boring Bits with Threaded Shank	319
ISO30 Chucks for "ER32" Precision Collets	250
ISO30 Chucks for "ER40" Precision Collets	249
ISO30 Retaining Studs	254
ITK-Plus® Crosscut Saw Blades	31
ITK-Plus® Fine Cut-Off Saw Blades	31
ITK-Plus® Non-Ferrous Metal & Composite Decking.....	32
ITK-Plus® Rip & Crosscut Saw Blades.....	30
ITK-Plus® Ripping Saw Blades.....	30

J	
Jig Saw Blades	53-57
Junior Ogee Rail & Stile Set.....	213

